

XG-A-01-2025/04-1000

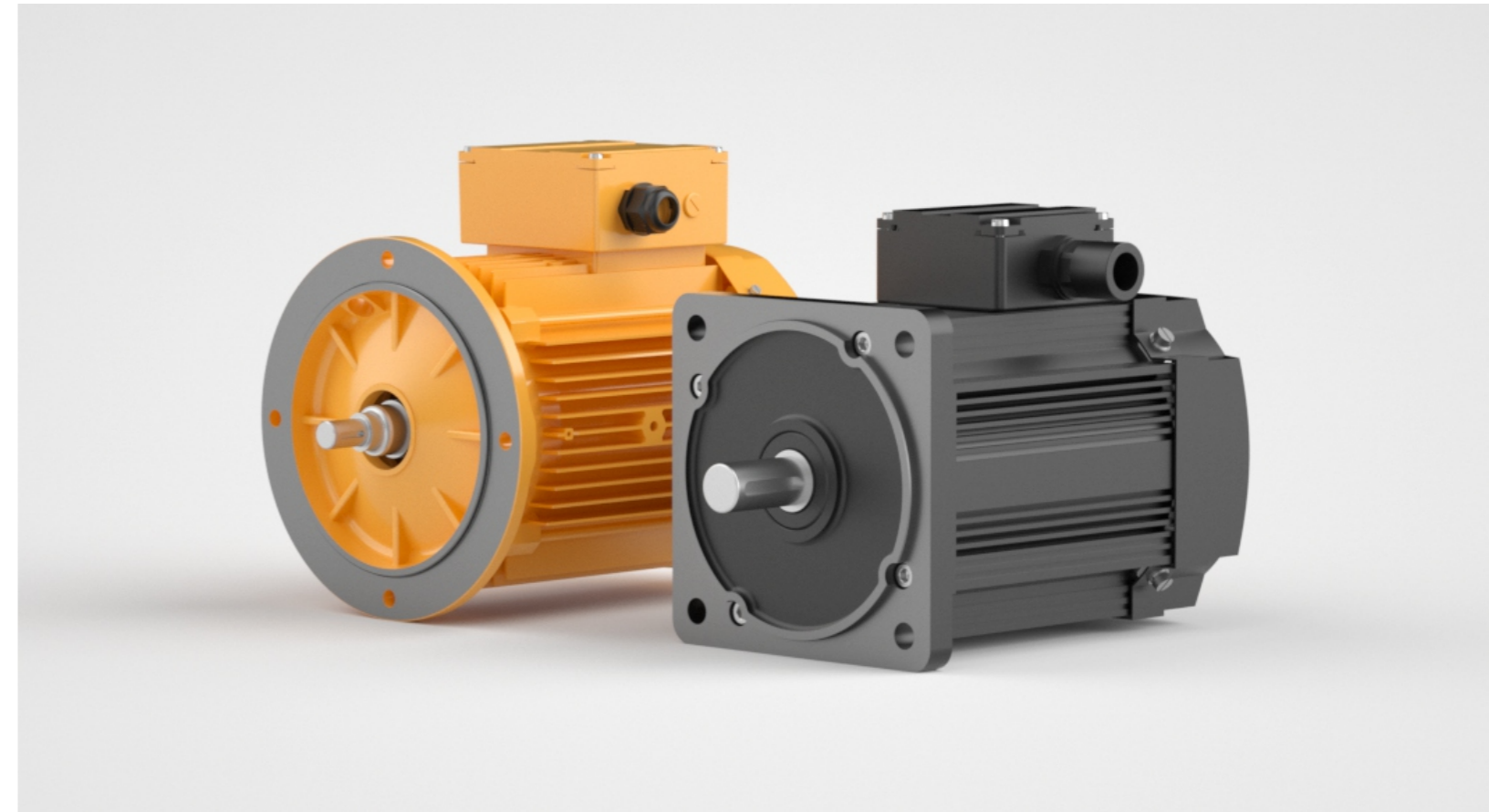

星光传动官方网站



星光传动官方微信

广东星光传动股份有限公司
GUANGDONG STARSHINE DRIVE CO., LTD.

广东省佛山市三水区白坭镇汇金工业城 10 号
ADD: NO.10,Huijin Industrial park, Baini Town,Sanshui district,Foshan,Guangdong,China

HTTP://www.xgcd.cn 中文域名: 星光传动 . 网址
TEL: 400 850 5665 FAX:0757-66639837/838
E-MAIL:xg-sales@xgcd.cn

永磁同步电动机

PERMANENT MAGNET SYNCHRONOUS MOTOR

动静之间 · 唯简不凡



广东星光传动股份有限公司前身是一家创建于1965年的国有军工企业——国营星光工模具厂，公司在追求全体员工物质和精神双重幸福的同时，以行业领先的减变速机应用技术，驱动全球工业革新为使命，建设觉悟型组织，成为服务全球的幸福企业为愿景。

公司技术力量雄厚，现有员工420余人，其中工程技术人员40多名，和各种先进的加工制造和检测设备，依托省级工程技术研究中心、减速机产品试验室和现代化研发和生产基地，为高端减变速机产品的行业应用开发和服务提供了良好的发展基础。

公司主导产品有：NCJ系列齿轮减速机、R/S/K/F系列高精度齿轮减速机、RV系列蜗杆减速器、SNKG系列齿轮减速机、JWB-X系列机械无级变速器、B/JXJ系列摆线针轮减速机、SCK系列准双曲面齿轮减速机等七大系列产品可供选用，公司广泛服务于陶瓷、纺织、玻璃、木工、高压开关、食品饮料、包装印刷、仓储物流、起重运输等装备制造和应用行业，专为中高端用户提供专业的产品和服务。产品畅销国内，远销欧美、中东、东南亚等20多个国家和地区。

在未来的发展中，星光传动聚焦客户需求，提供有竞争力的传动解决方案，持续为客户创造价值，打造高端制造业和终端用户“替代进口、升级换代”的首选品牌！

动静之间，唯简不凡；携手同行，星光灿烂！

Guangdong Starshine Drive Co.,Ltd, the predecessor was a state-owned military mould enterprise which established in 1965. While pursuing the spiritual and material happiness of all employees, With the Mission "with industry-leading reduction and transmission technology to drive industrial renewal" and Vision "Build a conscious organization, become a happy enterprise serving the world".

Starshine has a strong technical force with over 400 employees at present, including over 40 engineering technicians, and kinds of advanced processing machines and testing equipment. Thanks to the Provincial Engineering Technology Research Center, the speed reducer product laboratory, the modern R&D and production base, that make Starshine has a good foundation to develop and service for high-end speed reducers.

Our main products include: helical geared motor, worm gearboxes, planetary gearboxes, speed variators, cycloidal gearboxes, helical-hypoid gearboxes, which widely used in ceramic industry, glass industry, woodworking machinery, high voltage switch, food & beverage, packaging & printing, Storage & logistics, hoisting & transportation facilities...etc, Starshine technically provide the professional product & service for the medium and high-end customers, and our gearboxes are best-selling in both domestic and abroad market, such as Europe, North America, South America, Middle East, South Asia, Southeast Asia, Africa...etc more than 20 countries and regions.

In future, Starshine will hold the business creed of "serving customer, diligence & simplicity, self-criticism, innovation, honesty, teamwork", and take "authenticity, altruism, openness, innovation, responsibility, collaboration" as core values. Focus on customers' requirements and provide them the competitive transmission solution and create value for them constantly, and create a preferred brand of replacing import products and upgrading continuously for the end users.

Between Dynamic and Static, Simple is Extraordinary, let's go forward hand in hand and make a brilliant future!

目录

CONTENT



| | | | |
|---|-------|--|-------|
| 主要特点 Main Features | 00 | 电气性能参数 Electrical performance parameters | 06-12 |
| 型号说明 Model Description | 01-02 | 电机结构与安装型式 Motor structure and installation type | 13-21 |
| 技术特性 Technical Characteristics | 03 | 电机选订购指南 Motor Ordering Guide | 22 |
| 产品技术优势 Product Technology Advantages | 04-05 | | |

● 主要特点 Main Features

星光永磁同步电动机电机具有外形美观、高效率、低噪声、低振动、安全可靠、维护方便等特点，遵循模块化和最优化设计理念，全系列产品包括B3、B5、B35、B14等安装型式，同时支持独立风机、制动器、逆止器、编码器、变频器等的模块化组合与集成。

星光永磁同步电动机的能效符合IEC60034-30-1标准中的IE5效率级别以及GB 30253-2013标准的1级要求。该电机以配备永磁体的转子为特点，相较于感应电机，展现出更高的效率和功率密度，在相同功率和转矩输出下，其机座号更为紧凑。电机设计为自扇风冷，无需额外的强制风冷系统，即可在变频器驱动下实现调速运行，且在低速运行时能保持良好的恒转矩性能，调速范围宽广，并且在整个调速区间内均保持高效率。此外，各机座号的安装尺寸均与感应电机保持一致，且满足IEC及国家相关标准，便于用户的安装与操作。

The Starlight Permanent Magnet Synchronous Motors are characterized by their aesthetically pleasing design, high efficiency, low noise, low vibration, safety, reliability, and ease of maintenance. These motors are designed following modular and optimization principles, with a full range of products including B3, B5, B35, B14 mounting types. They also support modular integration with independent fans, brakes, non-reverse devices, encoders, and frequency converters.

The energy efficiency of the Starlight Permanent Magnet Synchronous Motors meets the IE5 efficiency level as per the IEC 60034-30-1 standard and the Class 1 requirements of the GB 30253-2013 standard. Featuring a rotor equipped with permanent magnets, these motors demonstrate higher efficiency and power density compared to induction motors, offering a more compact frame size for the same power and torque output. The motors are designed as self-ventilated, eliminating the need for additional forced air cooling systems, and can achieve speed regulation under inverter drive. They maintain excellent constant torque performance at low speeds, with a wide speed regulation range and high efficiency throughout the entire speed range. Additionally, the mounting dimensions for each frame size are consistent with those of induction motors and comply with IEC and national standards, facilitating easy installation and operation for users.

型号说明 Model Description

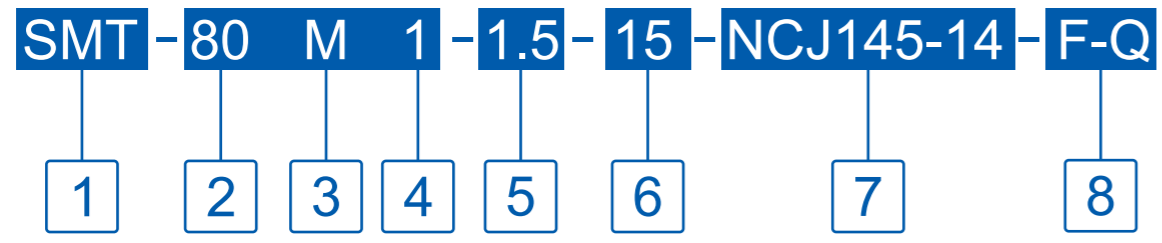
变频调速永磁同步电动机 Variable Frequency Speed Control Permanent Magnet Synchronous Motor

| | |
|---|--|
| 1 | 电机代号: SMT Motor code: SMT |
| 2 | 中心高 Center height: 71、80、90、100、112、132、160、180、200 方形机130/145对应80中心高, 方形机180对应100中心高 The histogram 130/145 corresponds to an 80 center high and the histogram 180 corresponds to a 100 center high. |
| 3 | 机座长 Frame length: S、M、L |
| 4 | 铁芯长度: 1/2, 对应规格只有一个铁芯长度时不写 Core length: 1/2, Do not write when there is only one iron core degree for the corresponding specification. |
| 5 | 额定功率 Rated output: 0.25-37kW |
| 6 | 额定转速: 10、15、20、30等。例如20代表额定转速: 20*100r/min=2000r/min Rated speed: 10, 15, 20, 30 and so on. For example, 20 represents the rated speed: 20*100r/ min= 2000r/ min |
| 7 | 安装方式 Mounting arrangement: 异步机壳电机的安装方式: B3、B5、B35、B14、B34、V1 Mounting arrangement of asynchronous frame motors: B3、B5、B35、B14、B34、V1 方形电机的安装方式: 法兰式 Mounting arrangement of square motor: flange-mounted 无极摆线直联电机: 0#、1#、2#、3#; Stepless cycloidal direct-drive motor: 0#、1#、2#、3#; NCJ系列直联电机: NCJ★-☆、SCK★-☆; NCJ Series direct-connected motors: NCJ★-☆、SCK★-☆; 四大系列直联电机: SH★ R/F/K/S Series direct-connected motors: SH★ 注: ★表示法兰号; ☆表示轴头直径。 Note: ★ indicates flange number; ☆ indicates shaft end diameter. |
| 8 | 附件信息 Attachment Information: Y: 异步机壳; F: 方形机壳 Y: Asynchronous frame F: Square frame Q: 变频器和电机一体; 缺省: 单电机 Q: Inverter and motor-body Default: single motor 制动器: BE(无手释放制动器)、HR(手柄释放制动器)、HF(螺栓释放制动器) Brake: BE (no handle release brake)、HR (handle release brake)、HF (screw release brake) 强制冷风扇: V(三相)、VS(单相)、VR(24V直流) Forced cooling fan: V (three-phase), VS (single-phase), VR (24V DC) 高惯量飞轮风扇: Z Additional flywheel fan: Z 逆止器 Backstop: RS 热敏电阻保护装置: TF Thermistor protection device: TF 恒温器保护装置: TH Thermostat protection device: TH PT100温度传感器: PT PT100 temperature sensor: PT 编码器 Encoder: E 防雨帽 Protective cowl: C 无风叶 No fan: U 双出轴: 2WE Double output shaft of the motor: 2WE 注: 包含多个附件信息时, 按照表中上到下的顺序排列, 两附件信息之间用“-”隔开 Note: When multiple attachments are included, they are listed in the order from top to bottom of the table, and two attachments are separated by a “-”. |

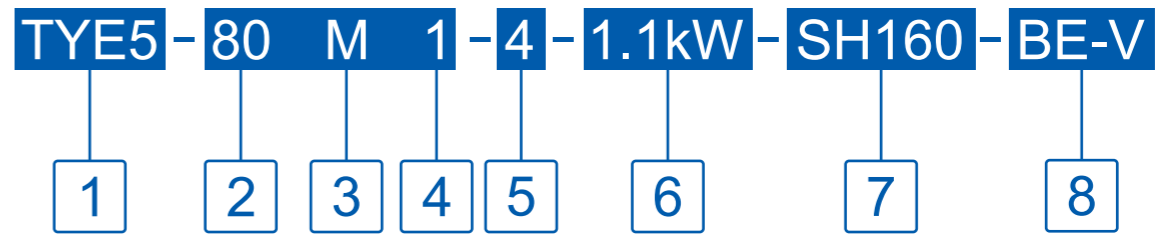
异步起动永磁同步电动机 Line-Start Permanent Magnet Synchronous Motor

| | |
|---|--|
| 1 | 电机代号: T表示同步电机, Y表示异步起动, E5代表IE5能效; Motor Code: T-synchronization, Y- motor、E5- IE5 energy efficiency. |
| 2 | 中心高 Center height: 71、80、90、100、112、132、160、180、200 |
| 3 | 机座长 Frame length: S、M、L |
| 4 | 铁芯长度: 1/2, 对应规格只有一个铁芯长度时不写 Core length: 1/2, Do not write when there is only one iron core length for the corresponding specification. |
| 5 | 电机极数 Pole of motor: 2、4、6、8、10 |
| 6 | 额定功率 Rated output: 0.25-37kW |
| 7 | 安装方式 Mounting arrangement: 标准电机: B3、B5、B35、V1、B14、B34; Standard motor: B3、B5、B35、V1、B14、B34; 无极摆线直联电机: 0#、1#、2#、3#; Stepless cycloidal direct-drive motor: 0#、1#、2#、3#; NCJ系列直联电机: NCJ★/☆、SCK★/☆; NCJ Series direct-connected motors: NCJ★/☆、SCK★/☆; 四大系列直联电机: SH★ R/F/K/S Series direct-connected motors: SH★ 注: ★表示法兰号; ☆表示轴头直径。 Note: ★ indicates flange number; ☆ indicates shaft end diameter. |
| 8 | 附件信息 Attachment Information: Y: 异步机壳; F: 方形机壳 Y: Asynchronous frame F: Square frame 制动器: BE(无手释放装置的制动器)、HR(手柄释放制动器)、HF(螺栓释放制动器) Brake: BE (no handle release brake)、HR (handle release brake)、HF (screw release brake) 强制冷风扇: V(三相)、VS(单相)、VR(24V直流) Forced cooling fan: V (three-phase), VS (single-phase), VR (24V DC) 高惯量飞轮风扇: Z Additional flywheel Fan: Z 逆止器 Backstop: RS 热敏电阻保护装置: TF Thermistor protection device: TF 恒温器保护装置: TH Thermostat protection device: TH PT100温度传感器: PT PT100 temperature sensor: PT 编码器 Encoder: E 防雨帽 Protective cowl: C 无风叶 No fan: : U 双出轴: 2WE Double output shaft of the motor: 2WE 注: 包含多个附件信息时, 按照表中上到下的顺序排列, 两附件信息之间用“-”隔开 Note: When multiple attachments are included, they are listed in the order from top to bottom of the table, and two attachments are separated by a “-”. |

技术特性 Technical characteristics

| 项目 | 电机特性 Motor characteristics | |
|------------------------------------|------------------------------------|--|
| | 标准特性 Standard characteristics | 可选 (特殊) 特性 Optional (special) characteristics |
| 机座号 Frame size | 71~200 | |
| 额定功率 Rated output | 0.25 ~ 37KW | |
| 额定转速 Rated speed | 3000、2000、1500、1000和750r/min | |
| 额定电压 Rated voltage | 380V | |
| 工作制 Duty cycle | S1 | |
| 效率等级 Efficiency pole | IE5&GB 1 级 | |
| 安装方式 Mounting arrangement | 法兰型 Flange-mounted | B3 |
| 绝缘等级 Insulation class | F 级 (Δ T 80K) | |
| 服务系数 Service factor | 1 | |
| 防护等级 Degree of protection | IP55 | |
| 冷却方式 Cooling method | IC411 | |
| 机壳类型 Frame type | 方形机壳 Square frame | 异步机壳 Asynchronous frame |
| 机壳材质 Frame material | 铸铝 Cast aluminum | |
| 接线盒材质 Terminal box Material | 铸铝 Cast aluminum | |
| 接线盒位置 Terminal box position | 电机顶部 Top of motor | |
| 轴承润滑 Bearing lubrication | 免维护轴承 Maintenance-free bearings | |
| 电机保护装置 Motor protection devices | 带保护装置 Have protection device | |
| 变频器 inverter | 带变频器 Have inverter | |
| 面漆颜色 Top coat color | 哑光黑 Matte black | 星光灰 Starlight gray |
| | 可定制 Customizable | |

技术优势 Product Technology Advantages

▲大功率密度优势 – 减少质量和体积 Major power density benefits – reduced mass and volume
 永磁同步电动机IE5和同功率同转速感应电机 IE3 相比体积缩小 1-2 个机座号，既提高了电机的效率，同时也减少电机质量和体积。电机的轴和轴承能够在更小的机壳尺寸里承受更高的功率和扭矩。
 The permanent magnet synchronous motor IE5 is 1-2 frame sizes smaller than the induction motor IE3 of the same power and the same rotational speed, which not only increases the efficiency of the motor, but also reduces the mass and volume of the motor. The motor's shaft and bearings are able to be mounted in a more flexible manner. The motor's shaft and bearings can accommodate higher power and torque in a smaller frame size.

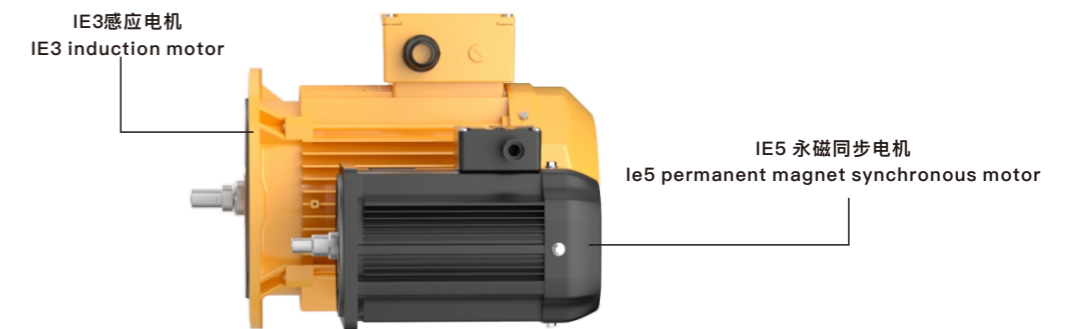

图：用于比较的电机为 1500r/min 的 IE5 永磁同步电机和 IE3 感应电机，均为 4kW，体积减小、重量减轻。
 Fig.: Compared to the IE5 permanent magnet synchronous motor and IE3 induction motor with a speed of 1500r/min, both of which are 4kW, the IE5 permanent magnet synchronous motor and IE3 induction motor have reduced size and weight.

▲在宽泛的调速范围内维持恒转矩 Maintains constant torque over a wide speed range
 永磁同步电动机可以以恒转矩在很宽的转速范围内运行，无需使用强制通风。这一特性使其成为需要速度变化和恒定转矩的应用的理想选择，即使在低速情况下，也不需要编码器。
 Permanent magnet synchronous motors can be operated with constant torque over a wide speed range without the use of forced ventilation. This feature makes them ideal for applications requiring speed variation and constant torque, even at low speeds, without the need for an encoder.

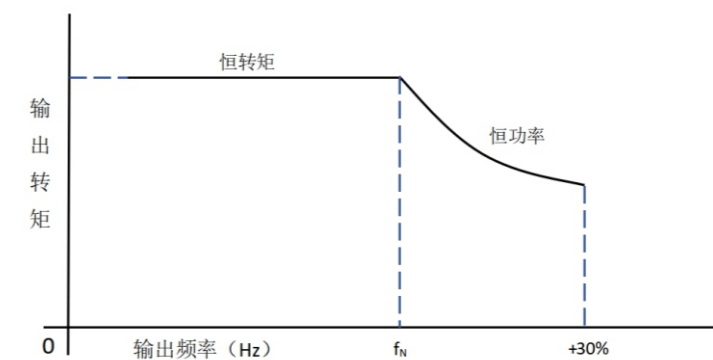

技术优势 Product Technology Advantages

▲电机损耗降低 Reduction of motor losses

与 IE3 感应电机相比，损耗大幅下降

Compared with IE3 induction motors, the power loss has been significantly reduced.

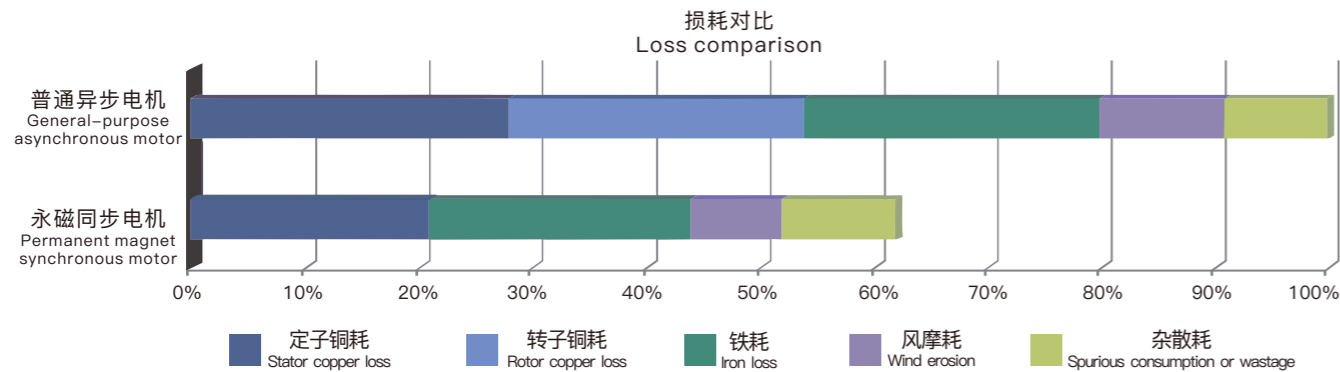

IE3 感应电机和 IE5 永磁同步电机的损耗对比

Comparison of losses between IE3 induction motors and IE5 permanent magnet synchronous motors

▲电机在全范围转速或负载下提供超高效率

The motor provides extremely high efficiency throughout the entire speed range or under the entire load conditions.

永磁同步电动机转子依靠永磁体产生磁场，无需无功励磁电流，可显著提高功率因数（可达到 1），不论转速或负载如何，均可提供超高效率。全调速范围内与感应电机相比具有卓越效率，特别是在低转速或低转矩输出情况下，效率和功率因数提升值更加显著。

The rotor of a permanent magnet synchronous motor generates a magnetic field by relying on permanent magnets, without the need for reactive excitation current. This significantly improves the power factor (up to 1), and can provide ultra-high efficiency regardless of the speed or load. Compared with induction motors within the full speed regulation range, it has excellent efficiency, especially in cases of low speed or low torque output, where the improvement in efficiency and power factor is more significant.

额定转速变转矩运行下的效率和功率因数曲线

The efficiency and power factor curves under the condition of variable torque operation at rated rotational speed

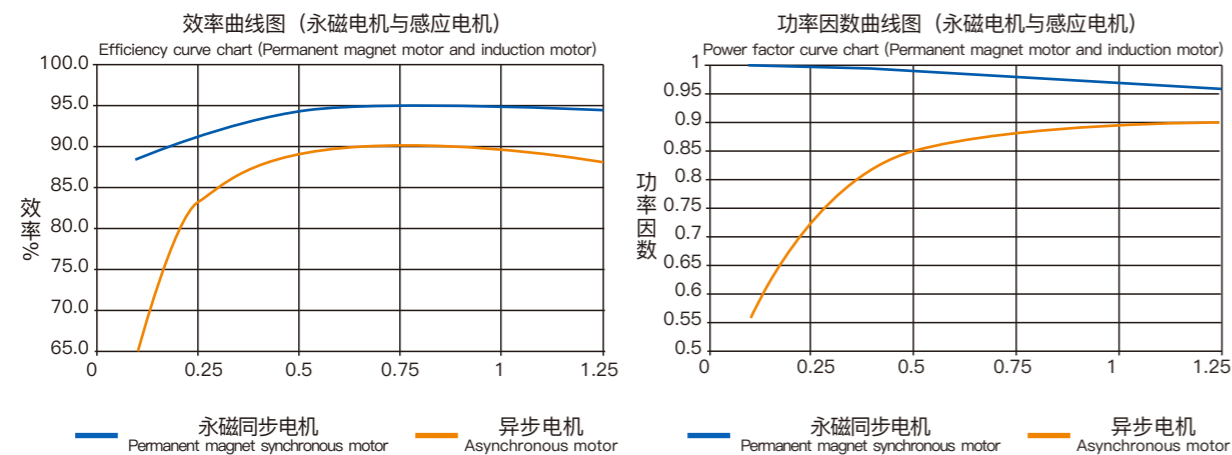

电气性能参数 Electrical performance parameters

SMT变频调速永磁同步电机 方形机座 2000r/min

SMT Variable Frequency Speed Control Permanent Magnet Synchronous Motor Square Base 2000r/min

| 型号 Type | 功率 Output | | 机座号 Frame Size | 满载转矩 Full-load Torque (Nm) | 极数 Pole 2p | 频率 Frequency Hz | 额定转速 Rated Speed (r/min) | 效率 Efficiency (%) | 功率因数 Power Factor cos φ |
|-------------------|--------------|-----|-------------------|-------------------------------|---------------|--------------------|-----------------------------|----------------------|----------------------------|
| | kW | HP | | | | | | | |
| SMT-80M-0.75-20-F | 0.75 | 1 | 80M | 3.58 | 10 | 166.67 | 2000 | 85.9 | 0.95 |
| SMT-80M-1.1-20-F | 1.1 | 1.5 | 80M | 5.25 | 10 | 166.67 | 2000 | 87.4 | 0.95 |
| SMT-80M-1.5-20-F | 1.5 | 2 | 80M | 7.16 | 10 | 166.67 | 2000 | 88.6 | 0.95 |
| SMT-80M-2.2-20-F | 2.2 | 3 | 80M | 10.51 | 10 | 166.67 | 2000 | 89.9 | 0.95 |
| SMT-80M-3-20-F | 3 | 4 | 80M | 14.33 | 10 | 166.67 | 2000 | 90.8 | 0.95 |
| SMT-100L-2.2-20-F | 2.2 | 3 | 100L | 10.51 | 10 | 166.67 | 2000 | 89.9 | 0.95 |
| SMT-100L-3-20-F | 3 | 4 | 100L | 14.33 | 10 | 166.67 | 2000 | 90.8 | 0.95 |
| SMT-100L-4-20-F | 4 | 5.5 | 100L | 19.10 | 10 | 166.67 | 2000 | 91.5 | 0.95 |
| SMT-100L-5.5-20-F | 5.5 | 7.5 | 100L | 26.26 | 10 | 166.67 | 2000 | 92.4 | 0.95 |

SMT变频调速永磁同步电机 方形机座 1500r/min

SMT Variable Frequency Speed Control Permanent magnet synchronous motor Square Base 1500r/min

| 型号 Type | 功率 Output | | 机座号 Frame Size | 满载转矩 Full-load Torque (Nm) | 极数 Pole 2p | 频率 Frequency Hz | 额定转速 Rated Speed (r/min) | 效率 Efficiency (%) | 功率因数 Power Factor cos φ |
|-------------------|--------------|-----|-------------------|-------------------------------|---------------|--------------------|-----------------------------|----------------------|----------------------------|
| | kW | HP | | | | | | | |
| SMT-80M-0.75-15-F | 0.75 | 1 | 80M | 4.78 | 10 | 125 | 1500 | 87.8 | 0.95 |
| SMT-80M-1.1-15-F | 1.1 | 1.5 | 80M | 7 | 10 | 125 | 1500 | 89.2 | 0.95 |
| SMT-80M-1.5-15-F | 1.5 | 2 | 80M | 9.55 | 10 | 125 | 1500 | 90.1 | 0.95 |
| SMT-80M-2.2-15-F | 2.2 | 3 | 80M | 14 | 10 | 125 | 1500 | 91.1 | 0.95 |
| SMT-100L-2.2-15-F | 2.2 | 3 | 100L | 14 | 10 | 125 | 1500 | 91.1 | 0.95 |
| SMT-100L-3-15-F | 3 | 4 | 100L | 19.1 | 10 | 125 | 1500 | 91.8 | 0.95 |
| SMT-100L-4-15-F | 4 | 5.5 | 100L | 25.47 | 10 | 125 | 1500 | 92.6 | 0.95 |

电气性能参数 Electrical performance parameters
SMT变频调速永磁同步电机 异步机座 3000r/min

SMT Variable Frequency Speed Control Permanent Magnet Synchronous Motor Asynchronous Machine Base 3000r/min

| 型号 Type | 功率 Output | | 机座号 Frame Size | 满载转矩 Full-load Torque (Nm) | 额定电流 Rated Current (A) | 极数 Pole 2p | 频率 Frequency Hz | 额定转速 Rated Speed (r/min) | 效率 Efficiency (%) | 功率因数 Power Factor cos φ |
|--------------------|--------------|-----|-------------------|----------------------------------|------------------------------|------------------|-----------------------|--------------------------------|-------------------------|-------------------------------|
| | kW | HP | | | | | | | | |
| SMT-90S-2.2-30-Y | 2.2 | 3 | 90S | 7 | 3.94 | 8 | 200 | 3000 | 92.5 | 0.95 |
| SMT-90L-3-30-Y | 3 | 4 | 90L | 9.6 | 5.38 | 8 | 200 | 3000 | 92.8 | 0.95 |
| SMT-90L-4-30-Y | 4 | 5.5 | 90L | 12.7 | 7.07 | 8 | 200 | 3000 | 93.4 | 0.95 |
| SMT-100L-3-30-Y | 3 | 4 | 100L | 9.6 | 5.36 | 8 | 200 | 3000 | 92.9 | 0.95 |
| SMT-100L-4-30-Y | 4 | 5.5 | 100L | 12.7 | 7.04 | 8 | 200 | 3000 | 93.5 | 0.95 |
| SMT-100L-5.5-30-Y | 5.5 | 7.5 | 100L | 17.5 | 9.65 | 8 | 200 | 3000 | 94.1 | 0.95 |
| SMT-112M-5.5-30-Y | 5.5 | 7.5 | 112M | 17.5 | 9.54 | 8 | 200 | 3000 | 94.4 | 0.95 |
| SMT-112M-7.5-30-Y | 7.5 | 10 | 112M | 23.9 | 12.9 | 8 | 200 | 3000 | 94.8 | 0.95 |
| SMT-112M-11-30-Y | 11 | 15 | 112M | 35 | 19.2 | 8 | 200 | 3000 | 95.1 | 0.95 |
| SMT-132S-11-30-Y | 11 | 15 | 132S | 35 | 19.1 | 8 | 200 | 3000 | 95.4 | 0.95 |
| SMT-132M-15-30-Y | 15 | 20 | 132M | 47.8 | 26.5 | 8 | 200 | 3000 | 95.4 | 0.95 |
| SMT-132M-18.5-30-Y | 18.5 | 25 | 132M | 58.9 | 32.2 | 8 | 200 | 3000 | 95.8 | 0.95 |
| SMT-160M-11-30-Y | 11 | 15 | 160M | 35 | 19.5 | 8 | 200 | 3000 | 95.5 | 0.95 |
| SMT-160M-15-30-Y | 15 | 20 | 160M | 47.8 | 26.7 | 8 | 200 | 3000 | 95.5 | 0.95 |
| SMT-160M-18.5-30-Y | 18.5 | 25 | 160M | 58.9 | 32.5 | 8 | 200 | 3000 | 95.8 | 0.95 |
| SMT-160M-22-30-Y | 22 | 30 | 160M | 70 | 37.6 | 8 | 200 | 3000 | 95.9 | 0.95 |
| SMT-160L-18.5-30-Y | 18.5 | 25 | 160L | 58.9 | 32.5 | 8 | 200 | 3000 | 95.8 | 0.95 |
| SMT-160L-22-30-Y | 22 | 30 | 160L | 70 | 37.6 | 8 | 200 | 3000 | 95.9 | 0.95 |

SMT变频调速永磁同步电机 异步机座 1500r/min

SMT Variable Frequency Speed Control Permanent Magnet Synchronous Motor Asynchronous Machine Base 1500r/min

| 型号 Type | 功率 Output | | 机座号 Frame Size | 满载转矩 Full-load Torque (Nm) | 额定电流 Rated Current (A) | 极数 Pole 2p | 频率 Frequency Hz | 额定转速 Rated Speed (r/min) | 效率 Efficiency (%) | 功率因数 Power Factor cos φ |
|--------------------|--------------|------|-------------------|----------------------------------|------------------------------|------------------|-----------------------|--------------------------------|-------------------------|-------------------------------|
| | kW | HP | | | | | | | | |
| SMT-80M-0.55-15-Y | 0.55 | 0.75 | 80 | 3.5 | 1.06 | 8 | 100 | 1500 | 88.6 | 0.94 |
| SMT-80M-0.75-15-Y | 0.75 | 1 | 80 | 4.8 | 1.43 | 8 | 100 | 1500 | 88.8 | 0.94 |
| SMT-90S-1.1-15-Y | 1.1 | 1.5 | 90S | 7 | 2.03 | 8 | 100 | 1500 | 89.9 | 0.94 |
| SMT-90S-1.5-15-Y | 1.5 | 2 | 90S | 9.6 | 2.74 | 8 | 100 | 1500 | 90.7 | 0.95 |
| SMT-90L-1.5-15-Y | 1.5 | 2 | 90L | 9.6 | 2.74 | 8 | 100 | 1500 | 90.7 | 0.95 |
| SMT-90L-2.2-15-Y | 2.2 | 3 | 90L | 14 | 4.02 | 8 | 100 | 1500 | 92.1 | 0.95 |
| SMT-90L-3-15-Y | 3 | 4 | 90L | 19.1 | 5.42 | 8 | 100 | 1500 | 92.6 | 0.95 |
| SMT-100L-2.2-15-Y | 2.2 | 3 | 100L | 14 | 3.98 | 8 | 100 | 1500 | 92.2 | 0.95 |
| SMT-100L-3-15-Y | 3 | 4 | 100L | 19.1 | 5.38 | 8 | 100 | 1500 | 92.6 | 0.95 |
| SMT-100L-4-15-Y | 4 | 5.5 | 100L | 25.5 | 7.26 | 8 | 100 | 1500 | 92.7 | 0.95 |
| SMT-112M-4-15-Y | 4 | 5.5 | 112M | 25.5 | 7.2 | 8 | 100 | 1500 | 92.7 | 0.95 |
| SMT-112M-5.5-15-Y | 5.5 | 7.5 | 112M | 35 | 9.86 | 8 | 100 | 1500 | 92.9 | 0.95 |
| SMT-112M-7.5-15-Y | 7.5 | 10 | 112M | 47.8 | 13.4 | 8 | 100 | 1500 | 92.9 | 0.95 |
| SMT-132S-5.5-15-Y | 5.5 | 7.5 | 132S | 35 | 9.7 | 8 | 100 | 1500 | 93.5 | 0.95 |
| SMT-132S-7.5-15-Y | 7.5 | 10 | 132S | 47.8 | 13.5 | 8 | 100 | 1500 | 93.5 | 0.95 |
| SMT-132S-11-15-Y | 11 | 15 | 132S | 70 | 19.4 | 8 | 100 | 1500 | 94 | 0.95 |
| SMT-132M-7.5-15-Y | 7.5 | 10 | 132M | 47.8 | 13.5 | 8 | 100 | 1500 | 93.5 | 0.95 |
| SMT-132M-11-15-Y | 11 | 15 | 132M | 70 | 19.4 | 8 | 100 | 1500 | 94 | 0.95 |
| SMT-132M-15-15-Y | 15 | 20 | 132M | 95.5 | 26.5 | 8 | 100 | 1500 | 94.5 | 0.95 |
| SMT-160M-11-15-Y | 11 | 15 | 160M | 70 | 20.2 | 8 | 100 | 1500 | 94.1 | 0.95 |
| SMT-160M-15-15-Y | 15 | 20 | 160M | 95.5 | 27.1 | 8 | 100 | 1500 | 94.5 | 0.95 |
| SMT-160M-18.5-15-Y | 18.5 | 25 | 160M | 117.8 | 33.5 | 8 | 100 | 1500 | 94.5 | 0.95 |
| SMT-160L-15-15-Y | 15 | 20 | 160L | 95.5 | 27.1 | 8 | 100 | 1500 | 94.5 | 0.95 |
| SMT-160L-18.5-15-Y | 18.5 | 25 | 160L | 117.8 | 33.5 | 8 | 100 | 1500 | 94.5 | 0.95 |
| SMT-160L-22-15-Y | 22 | 30 | 160L | 140.1 | 40.2 | 8 | 100 | 1500 | 94.7 | 0.95 |
| SMT-180M-18.5-15-Y | 18.5 | 25 | 180M | 117.8 | 31.6 | 8 | 100 | 1500 | 95.5 | 0.96 |
| SMT-180M-22-15-Y | 22 | 30 | 180M | 140.1 | 37.8 | 8 | 100 | 1500 | 95.6 | 0.96 |
| SMT-180L-22-15-Y | 22 | 30 | 180L | 140.1 | 37.8 | 8 | 100 | 1500 | 95.6 | 0.96 |
| SMT-180L-30-15-Y | 30 | 40 | 180L | 191 | 50.8 | 8 | 100 | 1500 | 95.9 | 0.96 |
| SMT-180L-37-15-Y | 37 | 50 | 180L | 235.6 | 62.4 | 8 | 100 | 1500 | 96.3 | 0.96 |

电气性能参数 Electrical performance parameters
SMT变频调速永磁同步电机 异步机座 1000r/min

SMT Variable Frequency Speed Control Permanent Magnet Synchronous Motor Asynchronous Machine Base 1000r/min

| 型号 Type | 功率 Output | | 机座号 Frame Size | 满载转矩 Full-load Torque (Nm) | 额定电流 Rated Current (A) | 极数 Pole 2p | 频率 Frequency Hz | 额定转速 Rated Speed (r/min) | 效率 Efficiency (%) | 功率因数 Power Factor cos φ |
|--------------------|--------------|-----|-------------------|----------------------------------|------------------------------|------------------|-----------------------|--------------------------------|-------------------------|-------------------------------|
| | kW | HP | | | | | | | | |
| SMT-100L-3-10-Y | 3 | 4 | 100L | 28.7 | 5.36 | 8 | 66.7 | 1000 | 93 | 0.95 |
| SMT-112M-4-10-Y | 4 | 5.5 | 112M | 38.2 | 7.26 | 8 | 66.7 | 1000 | 93.3 | 0.95 |
| SMT-132S-5.5-10-Y | 5.5 | 7.5 | 132S | 52.5 | 9.8 | 8 | 66.7 | 1000 | 93.5 | 0.95 |
| SMT-132M-4-10-Y | 4 | 5.5 | 132M | 38.2 | 7.2 | 8 | 66.7 | 1000 | 93.2 | 0.95 |
| SMT-132M-5.5-10-Y | 5.5 | 7.5 | 132M | 52.5 | 9.9 | 8 | 66.7 | 1000 | 93.4 | 0.95 |
| SMT-132M-7.5-10-Y | 7.5 | 10 | 132M | 71.6 | 13.3 | 8 | 66.7 | 1000 | 94.1 | 0.95 |
| SMT-132M-11-10-Y | 11 | 15 | 132M | 105.1 | 19.3 | 8 | 66.7 | 1000 | 94.6 | 0.95 |
| SMT-160M-7.5-10-Y | 7.5 | 10 | 160M | 71.6 | 13.4 | 8 | 66.7 | 1000 | 94.2 | 0.95 |
| SMT-160M-11-10-Y | 11 | 15 | 160M | 105.1 | 19.5 | 8 | 66.7 | 1000 | 94.6 | 0.95 |
| SMT-160L-11-10-Y | 11 | 15 | 160L | 105.1 | 19.5 | 8 | 66.7 | 1000 | 94.6 | 0.95 |
| SMT-160L-15-10-Y | 15 | 20 | 160L | 143.3 | 26.2 | 8 | 66.7 | 1000 | 95 | 0.95 |
| SMT-160L-18.5-10-Y | 18.5 | 25 | 160L | 176.7 | 32.6 | 8 | 66.7 | 1000 | 95.4 | 0.95 |
| SMT-180M-15-10-Y | 15 | 20 | 180M | 143.3 | 26.7 | 8 | 66.7 | 1000 | 95.2 | 0.95 |
| SMT-180M-18.5-10-Y | 18.5 | 25 | 180M | 176.7 | 32.4 | 8 | 66.7 | 1000 | 95.5 | 0.95 |
| SMT-180M-22-10-Y | 22 | 30 | 180M | 210.1 | 38.1 | 8 | 66.7 | 1000 | 95.7 | 0.96 |
| SMT-180L-15-10-Y | 15 | 20 | 180L | 143.3 | 26.7 | 8 | 66.7 | 1000 | 95.2 | 0.95 |
| SMT-180L-18.5-10-Y | 18.5 | 25 | 180L | 176.7 | 32.4 | 8 | 66.7 | 1000 | 95.5 | 0.95 |
| SMT-180L-22-10-Y | 22 | 30 | 180L | 210.1 | 38.1 | 8 | 66.7 | 1000 | 95.7 | 0.96 |
| SMT-180L-30-10-Y | 30 | 40 | 180L | 286.5 | 51.4 | 8 | 66.7 | 1000 | 95.9 | 0.96 |

SMT变频调速永磁同步电机 异步机座 750r/min

SMT Variable Frequency Speed Control Permanent Magnet Synchronous Motor Asynchronous Machine Base 750r/min

| 型号 Type | 功率 Output | | 机座号 Frame Size | 满载转矩 Full-load Torque (Nm) | 额定电流 Rated Current (A) | 极数 Pole 2p | 频率 Frequency Hz | 额定转速 Rated Speed (r/min) | 效率 Efficiency (%) | 功率因数 Power Factor cos φ |
|---------------------|--------------|-----|-------------------|----------------------------------|------------------------------|------------------|-----------------------|--------------------------------|-------------------------|-------------------------------|
| | kW | HP | | | | | | | | |
| SMT-112M-1.5-7.5-Y | 1.5 | 2 | 112M | 19.1 | 2.78 | 8 | 50 | 750 | 90.1 | 0.95 |
| SMT-112M-2.2-7.5-Y | 2.2 | 3 | 112M | 28 | 4.05 | 8 | 50 | 750 | 90.3 | 0.95 |
| SMT-112M-3-7.5-Y | 3 | 4 | 112M | 38.2 | 5.45 | 8 | 50 | 750 | 91.2 | 0.95 |
| SMT-132S-2.2-7.5-Y | 2.2 | 3 | 132S | 28 | 4.08 | 8 | 50 | 750 | 90.3 | 0.95 |
| SMT-132S-3-7.5-Y | 3 | 4 | 132S | 38.2 | 5.5 | 8 | 50 | 750 | 91.2 | 0.95 |
| SMT-132S-4-7.5-Y | 4 | 5.5 | 132S | 50.9 | 7.3 | 8 | 50 | 750 | 92 | 0.95 |
| SMT-132M-3-7.5-Y | 3 | 4 | 132M | 38.2 | 5.5 | 8 | 50 | 750 | 91.2 | 0.95 |
| SMT-132M-4-7.5-Y | 4 | 5.5 | 132M | 50.9 | 7.3 | 8 | 50 | 750 | 92 | 0.95 |
| SMT-132M-5.5-7.5-Y | 5.5 | 7.5 | 132M | 70 | 9.9 | 8 | 50 | 750 | 92.8 | 0.95 |
| SMT-160M-4-7.5-Y | 4 | 5.5 | 160M | 50.9 | 7.2 | 8 | 50 | 750 | 92.1 | 0.95 |
| SMT-160M-5.5-7.5-Y | 5.5 | 7.5 | 160M | 70 | 9.8 | 8 | 50 | 750 | 92.9 | 0.95 |
| SMT-160M-7.5-7.5-Y | 7.5 | 10 | 160M | 95.5 | 13.3 | 8 | 50 | 750 | 93.3 | 0.95 |
| SMT-160M-5.5-7.5-Y | 5.5 | 7.5 | 160M | 70 | 9.8 | 8 | 50 | 750 | 92.9 | 0.95 |
| SMT-160L-7.5-7.5-Y | 7.5 | 10 | 160L | 95.5 | 13.3 | 8 | 50 | 750 | 93.3 | 0.95 |
| SMT-160L-11-7.5-Y | 11 | 15 | 160L | 140.1 | 19.7 | 8 | 50 | 750 | 93.8 | 0.95 |
| SMT-160L-15-7.5-Y | 15 | 20 | 160L | 191 | 26.6 | 8 | 50 | 750 | 94.3 | 0.95 |
| SMT-180M-11-7.5-Y | 11 | 15 | 180M | 140.1 | 19.8 | 8 | 50 | 750 | 93.8 | 0.95 |
| SMT-180M-15-7.5-Y | 15 | 20 | 180M | 191 | 26.8 | 8 | 50 | 750 | 94.4 | 0.95 |
| SMT-180M-18.5-7.5-Y | 18.5 | 25 | 180M | 235.6 | 32.4 | 8 | 50 | 750 | 94.8 | 0.95 |
| SMT-180M-22-7.5-Y | 22 | 30 | 180M | 280.1 | 39 | 8 | 50 | 750 | 95 | 0.95 |
| SMT-180L-11-7.5-Y | 11 | 15 | 180L | 140.1 | 19.8 | 8 | 50 | 750 | 93.8 | 0.95 |
| SMT-180L-15-7.5-Y | 15 | 20 | 180L | 191 | 26.8 | 8 | 50 | 750 | 94.4 | 0.95 |
| SMT-180L-18.5-7.5-Y | 18.5 | 25 | 180L | 235.6 | 32.4 | 8 | 50 | 750 | 94.8 | 0.95 |
| SMT-180L-22-7.5-Y | 22 | 30 | 180L | 280.1 | 39 | 8 | 50 | 750 | 95 | 0.95 |

电气性能参数 Electrical performance parameters
TYE5异步起动永磁同步电机, 4-POLE, 1500r/min, 50Hz

TYE5 Asynchronous Starter Permanent Magnet Synchronous Motor, 4-POLE, 1500r/min, 50Hz

| 型号 Type | 功率 Output (kW) | 电压 Voltage (V) | 额定转速 Rated Speed (r/min) | 额定电流 Rated Current (A) | 效率 Efficiency (%) | 功率因数 Power Factor (cosφ) | 堵转电流倍数 Locked-rotor Current Multiple | 堵转转矩倍数 Locked-rotor Torque Multiple | 最大转矩倍数 Peak Torque Multiple |
|--------------|----------------------|----------------------|--------------------------------|------------------------------|-------------------------|--------------------------------|--|---|-----------------------------------|
| TYE5-80M1-4 | 0.55 | 380 | 1500 | 1.01 | 84.5 | 0.98 | 6.6 | 2.0 | 2.5 |
| TYE5-80M2-4 | 0.75 | | 1500 | 1.35 | 85.6 | 0.98 | 6.8 | 2.0 | 2.5 |
| TYE5-90S-4 | 1.1 | | 1500 | 1.95 | 87.4 | 0.98 | 7.6 | 2.0 | 2.5 |
| TYE5-90L-4 | 1.5 | | 1500 | 2.53 | 88.1 | 0.98 | 7.6 | 2.0 | 2.5 |
| TYE5-100L1-4 | 2.2 | | 1500 | 3.79 | 89.7 | 0.98 | 7.6 | 2.0 | 2.5 |
| TYE5-100L2-4 | 3 | | 1500 | 5.13 | 90.3 | 0.98 | 7.6 | 2.5 | 2.8 |
| TYE5-112M-4 | 4 | | 1500 | 6.8 | 90.9 | 0.98 | 7.6 | 2.5 | 2.8 |
| TYE5-132S-4 | 5.5 | | 1500 | 9.23 | 92.1 | 0.98 | 7.6 | 2.5 | 2.8 |
| TYE5-132M-4 | 7.5 | | 1500 | 12.5 | 92.6 | 0.98 | 7.6 | 2.5 | 2.8 |
| TYE5-160M-4 | 11 | | 1500 | 18.2 | 93.6 | 0.98 | 7.6 | 2.5 | 2.8 |
| TYE5-160L-4 | 15 | 1500 | 24.7 | 94.0 | 0.98 | 7.6 | 2.5 | 2.8 | |

产品结构与安装型式 Motor structure and installation type
SMT变频调速永磁同步电机 方型机座安装及外形尺寸法兰式

Flange Type SMT Variable Frequency Speed Control Permanent Magnet Synchronous Motor Square Base Motor Installation And External Dimensions

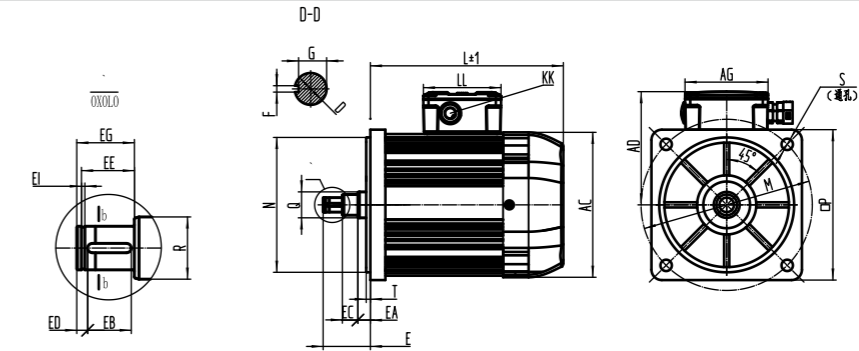

| 型号 Type | 转速 Speed (r/min) | AC | AD | AG | D | E | EA | EB | EC | ED | EE | EG | EI |
|-------------------|------------------------|-----|-----|----|----|------|----|----|----|-----|----|------|----------|
| SMT-80M-0.55-15-F | 1500 | 140 | 110 | 80 | 14 | 45.5 | 12 | 14 | 15 | 3.5 | 17 | 18.5 | 13.4x1.1 |
| SMT-80M-0.75-15-F | 1500 | 140 | 110 | 80 | 14 | 45.5 | 12 | 14 | 15 | 3.5 | 17 | 18.5 | 13.4x1.1 |
| SMT-80M-1.1-15-F | 1500 | 140 | 110 | 80 | 14 | 45.5 | 12 | 14 | 15 | 3.5 | 17 | 18.5 | 13.4x1.1 |
| SMT-80M-1.5-15-F | 1500 | 140 | 110 | 80 | 14 | 45.5 | 12 | 14 | 15 | 3.5 | 17 | 18.5 | 13.4x1.1 |
| SMT-80M-2.2-15-F | 1500 | 140 | 110 | 80 | 14 | 45.5 | 12 | 14 | 15 | 3.5 | 17 | 18.5 | 13.4x1.1 |
| SMT-80M-0.55-20-F | 2000 | 140 | 110 | 80 | 14 | 45.5 | 12 | 14 | 15 | 3.5 | 17 | 18.5 | 13.4x1.1 |
| SMT-80M-0.75-20-F | 2000 | 140 | 110 | 80 | 14 | 45.5 | 12 | 14 | 15 | 3.5 | 17 | 18.5 | 13.4x1.1 |
| SMT-80M-1.1-20-F | 2000 | 140 | 110 | 80 | 14 | 45.5 | 12 | 14 | 15 | 3.5 | 17 | 18.5 | 13.4x1.1 |
| SMT-80M-1.5-20-F | 2000 | 140 | 110 | 80 | 14 | 45.5 | 12 | 14 | 15 | 3.5 | 17 | 18.5 | 13.4x1.1 |
| SMT-80M-2.2-20-F | 2000 | 140 | 110 | 80 | 14 | 45.5 | 12 | 14 | 15 | 3.5 | 17 | 18.5 | 13.4x1.1 |
| SMT-100L-2.2-15-F | 1500 | 183 | 130 | 80 | 14 | 45.5 | 12 | 14 | 15 | 3.5 | 17 | 18.5 | 13.4x1.1 |
| SMT-100L-3-15-F | 1500 | 183 | 130 | 80 | 14 | 45.5 | 12 | 14 | 15 | 3.5 | 17 | 18.5 | 13.4x1.1 |
| SMT-100L-4-15-F | 1500 | 183 | 130 | 80 | 14 | 45.5 | 12 | 14 | 15 | 3.5 | 17 | 18.5 | 13.4x1.1 |
| SMT-100L-2.2-20-F | 2000 | 183 | 130 | 80 | 14 | 45.5 | 12 | 14 | 15 | 3.5 | 17 | 18.5 | 13.4x1.1 |
| SMT-100L-3-20-F | 2000 | 183 | 130 | 80 | 14 | 45.5 | 12 | 14 | 15 | 3.5 | 17 | 18.5 | 13.4x1.1 |
| SMT-100L-4-20-F | 2000 | 183 | 130 | 80 | 14 | 45.5 | 12 | 14 | 15 | 3.5 | 17 | 18.5 | 13.4x1.1 |
| SMT-100L-5.5-20-F | 2000 | 183 | 130 | 80 | 14 | 45.5 | 12 | 14 | 15 | 3.5 | 17 | 18.5 | 13.4x1.1 |

| 型号 Type | 转速 Speed (r/min) | F | G | L | LL | M | N | P | Q | R | S | T |
|-------------------|------------------------|---|------|-----|----|-----|-------|-----|----|----|------|-----|
| SMT-80M-0.55-15-F | 1500 | 3 | 12.2 | 197 | 75 | 165 | 130 | 145 | 25 | 20 | 11 | 4 |
| SMT-80M-0.75-15-F | 1500 | 3 | 12.2 | 197 | 75 | 165 | 130 | 145 | 25 | 20 | 11 | 4 |
| SMT-80M-1.1-15-F | 1500 | 3 | 12.2 | 207 | 75 | 165 | 130 | 145 | 25 | 20 | 11 | 4 |
| SMT-80M-1.5-15-F | 1500 | 3 | 12.2 | 227 | 75 | 165 | 130 | 145 | 25 | 20 | 11 | 4 |
| SMT-80M-2.2-15-F | 1500 | 3 | 12.2 | 267 | 75 | 165 | 130 | 145 | 25 | 20 | 11 | 4 |
| SMT-80M-0.55-20-F | 2000 | 3 | 12.2 | 197 | 75 | 165 | 130 | 145 | 25 | 20 | 11 | 4 |
| SMT-80M-0.75-20-F | 2000 | 3 | 12.2 | 197 | 75 | 165 | 130 | 145 | 25 | 20 | 11 | 4 |
| SMT-80M-1.1-20-F | 2000 | 3 | 12.2 | 197 | 75 | 165 | 130 | 145 | 25 | 20 | 11 | 4 |
| SMT-80M-1.5-20-F | 2000 | 3 | 12.2 | 212 | 75 | 165 | 130 | 145 | 25 | 20 | 11 | 4 |
| SMT-80M-2.2-20-F | 2000 | 3 | 12.2 | 242 | 75 | 165 | 130 | 145 | 25 | 20 | 11 | 4 |
| SMT-100L-2.2-15-F | 1500 | 3 | 12.2 | 198 | 75 | 200 | 114.3 | 180 | 25 | 20 | 13.5 | 3.2 |
| SMT-100L-3-15-F | 1500 | 3 | 12.2 | 218 | 75 | 200 | 114.3 | 180 | 25 | 20 | 13.5 | 3.2 |
| SMT-100L-4-15-F | 1500 | 3 | 12.2 | 248 | 75 | 200 | 114.3 | 180 | 25 | 20 | 13.5 | 3.2 |
| SMT-100L-2.2-20-F | 2000 | 3 | 12.2 | 188 | 75 | 200 | 114.3 | 180 | 25 | 20 | 13.5 | 3.2 |
| SMT-100L-3-20-F | 2000 | 3 | 12.2 | 208 | 75 | 200 | 114.3 | 180 | 25 | 20 | 13.5 | 3.2 |
| SMT-100L-4-20-F | 2000 | 3 | 12.2 | 238 | 75 | 200 | 114.3 | 180 | 25 | 20 | 13.5 | 3.2 |
| SMT-100L-5.5-20-F | 2000 | 3 | 12.2 | 280 | 75 | 200 | 114.3 | 180 | 25 | 20 | 13.5 | 3.2 |

产品结构及安装型式 Motor structure and installation type

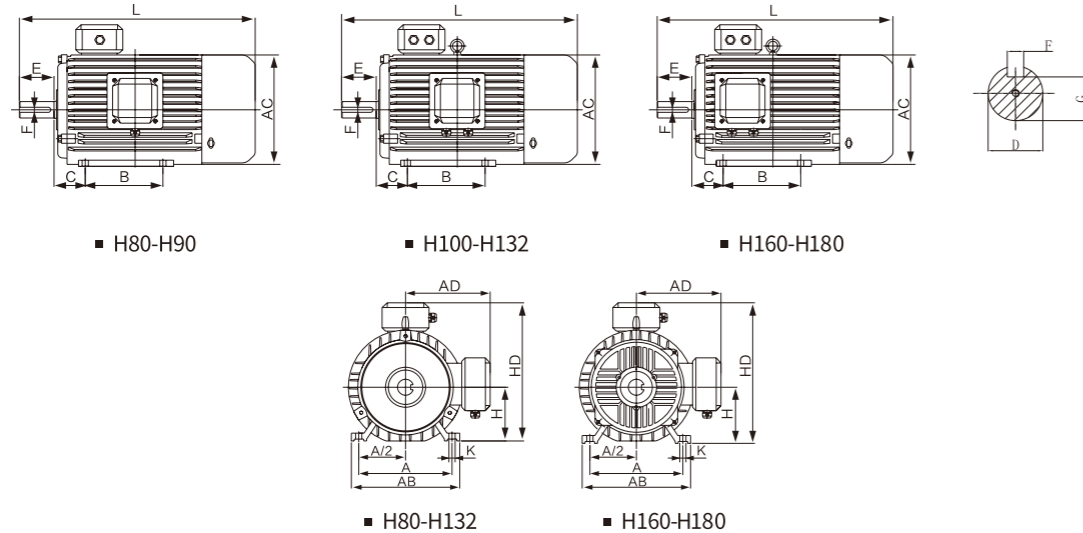
SMT变频调速永磁同步电机 异步机座安装及外形尺寸B3型
 B3 Type SMT Variable Frequency Speed Control Permanent Magnet Synchronous Motor Asynchronous Machine Base Motor Installation And External Dimensions

| 机座号 Frame Size | 转速 Speed (r/min) | A | A/2 | B | C | D | E | F | G |
|-------------------|------------------------|-----|-------|-----|-----------------------------|--|---------------------------|-------------------------------------|------------------------------------|
| 80 | 750~3000 | 112 | 62.5 | 100 | 50js14 _(±0.31) | 19k6 ^{+0.015} _{+0.002} | 40js9 _(±0.31) | 6N9 ⁰ _{-0.03} | 15.5 ⁰ _{-0.10} |
| 90S | 750~3000 | 125 | 70 | 100 | 56js14 _(±0.37) | 24k6 ^{+0.015} _{+0.002} | 50js9 _(±0.31) | 8N9 ⁰ _{-0.036} | 20 ⁰ _{-0.20} |
| 90L | 750~3000 | 140 | 70 | 125 | 56js14 _(±0.37) | 24k6 ^{+0.015} _{+0.002} | 50js9 _(±0.31) | 8N9 ⁰ _{-0.036} | 20 ⁰ _{-0.20} |
| 100L | 750~3000 | 140 | 80 | 140 | 63js14 _(±0.37) | 28k6 ^{+0.015} _{+0.002} | 60js9 _(±0.37) | 8N9 ⁰ _{-0.036} | 24 ⁰ _{-0.20} |
| 112M | 750~3000 | 160 | 95 | 140 | 70js14 _(±0.37) | 28k6 ^{+0.015} _{+0.002} | 60js9 _(±0.37) | 8N9 ⁰ _{-0.036} | 24 ⁰ _{-0.20} |
| 132S | 750~3000 | 190 | 108 | 140 | 89js14 _(±0.435) | 38k6 ^{+0.018} _{+0.002} | 80js9 _(±0.37) | 10N9 ⁰ _{-0.036} | 33 ⁰ _{-0.20} |
| 132M | 750~3000 | 216 | 108 | 178 | 89js14 _(±0.435) | 38k6 ^{+0.018} _{+0.002} | 80js9 _(±0.37) | 10N9 ⁰ _{-0.036} | 33 ⁰ _{-0.20} |
| 160M | 750~3000 | 216 | 127 | 210 | 108js14 _(±0.435) | 42k6 ^{+0.018} _{+0.002} | 110js9 _(±0.43) | 12N9 ⁰ _{-0.043} | 37 ⁰ _{-0.20} |
| 160L | 750~3000 | 254 | 127 | 254 | 108js14 _(±0.435) | 42k6 ^{+0.018} _{+0.002} | 110js9 _(±0.43) | 12N9 ⁰ _{-0.043} | 37 ⁰ _{-0.20} |
| 180M | 750~3000 | 254 | 139.5 | 241 | 121js14 _(±0.5) | 48k6 ^{+0.018} _{+0.002} | 110js9 _(±0.43) | 14N9 ⁰ _{-0.043} | 42.5 ⁰ _{-0.20} |
| 180L | 750~3000 | 279 | 139.5 | 279 | 121js14 _(±0.5) | 48k6 ^{+0.018} _{+0.002} | 110js9 _(±0.43) | 14N9 ⁰ _{-0.043} | 42.5 ⁰ _{-0.20} |

| 机座号 Frame Size | 转速 Speed (r/min) | H | K | AB | AC | AD | HD | L | L1 |
|-------------------|------------------------|-------------------------------------|------|-----|-----|-----|-----|-----|-----|
| 80 | 750~3000 | 80 ^{-0.1} _{-0.4} | 10 | 165 | 175 | 145 | 220 | 284 | 359 |
| 90S | 750~3000 | 90 ^{-0.1} _{-0.4} | 10 | 180 | 195 | 155 | 250 | 315 | 391 |
| 90L | 750~3000 | 90 ^{-0.1} _{-0.4} | 10 | 180 | 195 | 155 | 250 | 340 | 416 |
| 100L | 750~3000 | 100 ^{-0.1} _{-0.4} | 12 | 205 | 215 | 180 | 270 | 375 | 450 |
| 112M | 750~3000 | 112 ^{-0.1} _{-0.4} | 12 | 230 | 240 | 190 | 300 | 399 | 460 |
| 132S | 750~3000 | 132 ^{-0.1} _{-0.4} | 12 | 270 | 275 | 210 | 345 | 464 | 520 |
| 132M | 750~3000 | 132 ^{-0.1} _{-0.4} | 12 | 270 | 275 | 210 | 345 | 502 | 558 |
| 160M | 750~3000 | 160 ^{-0.1} _{-0.4} | 14.5 | 320 | 330 | 255 | 420 | 610 | 650 |
| 160L | 750~3000 | 160 ^{-0.1} _{-0.4} | 14.5 | 320 | 330 | 255 | 420 | 655 | 695 |
| 180M | 750~3000 | 180 ^{-0.1} _{-0.4} | 14.5 | 355 | 380 | 280 | 455 | 691 | 737 |
| 180L | 750~3000 | 180 ^{-0.1} _{-0.4} | 14.5 | 355 | 380 | 280 | 455 | 729 | 775 |

注:表格内白底部分电机外壳材质为铝壳, 灰底部分电机外壳材质为铁壳

产品结构及安装型式 Motor structure and installation type

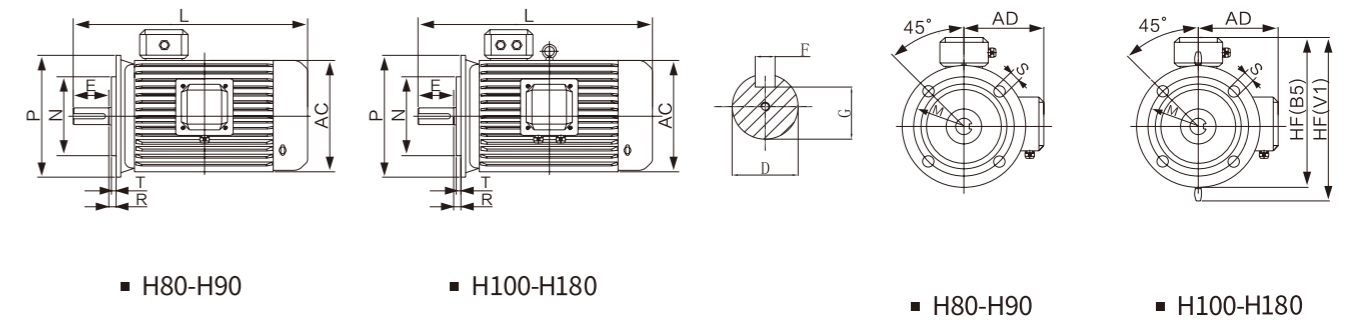
SMT变频调速永磁同步电机 异步机座安装及外形尺寸B5型
 B5 Type SMT Variable Frequency Speed Control Permanent Magnet Synchronous Motor Asynchronous Machine Base Motor Installation And External Dimensions

| 机座号 Frame Size | 转速 Speed (r/min) | A | A/2 | B | C | D | E | F | G | H | K | M |
|-------------------|------------------------|-----|-------|-----|-----------------------------|--|---------------------------|-------------------------------------|------------------------------------|-------------------------------------|------|-----|
| 80 | 750~3000 | 125 | 62.5 | 100 | 50js14 _(±0.31) | 19k6 ^{+0.015} _{+0.002} | 40js9 _(±0.31) | 6N9 ⁰ _{-0.03} | 15.5 ⁰ _{-0.10} | 80 ^{-0.1} _{-0.4} | 10 | 165 |
| 90S | 750~3000 | 140 | 70 | 100 | 56js14 _(±0.37) | 24k6 ^{+0.015} _{+0.002} | 50js9 _(±0.31) | 8N9 ⁰ _{-0.036} | 20 ⁰ _{-0.20} | 90 ^{-0.1} _{-0.4} | 10 | 165 |
| 90L | 750~3000 | 140 | 70 | 125 | 56js14 _(±0.37) | 24k6 ^{+0.015} _{+0.002} | 50js9 _(±0.31) | 8N9 ⁰ _{-0.036} | 20 ⁰ _{-0.20} | 90 ^{-0.1} _{-0.4} | 10 | 165 |
| 100L | 750~3000 | 160 | 80 | 140 | 63js14 _(±0.37) | 28k6 ^{+0.015} _{+0.002} | 60js9 _(±0.37) | 8N9 ⁰ _{-0.036} | 24 ⁰ _{-0.20} | 100 ^{-0.1} _{-0.4} | 12 | 215 |
| 112M | 750~3000 | 190 | 95 | 140 | 70js14 _(±0.37) | 28k6 ^{+0.015} _{+0.002} | 60js9 _(±0.37) | 8N9 ⁰ _{-0.036} | 24 ⁰ _{-0.20} | 112 ^{-0.1} _{-0.4} | 12 | 215 |
| 132S | 750~3000 | 216 | 108 | 140 | 89js14 _(±0.435) | 38k6 ^{+0.018} _{+0.002} | 80js9 _(±0.37) | 10N9 ⁰ _{-0.036} | 33 ⁰ _{-0.20} | 132 ^{-0.1} _{-0.4} | 12 | 265 |
| 132M | 750~3000 | 216 | 108 | 178 | 89js14 _(±0.435) | 38k6 ^{+0.018} _{+0.002} | 80js9 _(±0.37) | 10N9 ⁰ _{-0.036} | 33 ⁰ _{-0.20} | 132 ^{-0.1} _{-0.4} | 12 | 265 |
| 160M | 750~3000 | 254 | 127 | 210 | 108js14 _(±0.435) | 42k6 ^{+0.018} _{+0.002} | 110js9 _(±0.43) | 12N9 ⁰ _{-0.043} | 37 ⁰ _{-0.20} | 160 ^{-0.1} _{-0.4} | 14.5 | 300 |
| 160L | 750~3000 | 254 | 127 | 254 | 108js14 _(±0.435) | 42k6 ^{+0.018} _{+0.002} | 110js9 _(±0.43) | 12N9 ⁰ _{-0.043} | 37 ⁰ _{-0.20} | 160 ^{-0.1} _{-0.4} | 14.5 | 300 |
| 180M | 750~3000 | 279 | 139.5 | 241 | 121js14 _(±0.5) | 48k6 ^{+0.018} _{+0.002} | 110js9 _(±0.43) | 14N9 ⁰ _{-0.043} | 42.5 ⁰ _{-0.20} | 180 ^{-0.1} _{-0.4} | 14.5 | 300 |
| 180L | 750~3000 | 279 | 139.5 | 279 | 121js14 _(±0.5) | 48k6 ^{+0.018} _{+0.002} | 110js9 _(±0.43) | 14N9 ⁰ _{-0.043} | 42.5 ⁰ _{-0.20} | 180 ^{-0.1} _{-0.4} | 14.5 | 300 |

| 机座号 Frame Size | 转速 Speed (r/min) | N | P | R | S | T | 法兰孔数 Fange hdes | AB | AC | AD | HD | L | L1 |
|-------------------|------------------------|---|-----|---|------|-----|--------------------|-----|-----|-----|-----|-----|-----|
| 80 | 750~3000 | 130j6 ^{+0.014} _{+0.011} | 200 | 0 | 12 | 3.5 | 4 | 165 | 175 | 145 | 220 | 284 | 359 |
| 90S | 750~3000 | 130j6 ^{+0.014} _{+0.011} | 200 | 0 | 12 | 3.5 | 4 | 180 | 195 | 155 | 250 | 315 | 391 |
| 90L | 750~3000 | 130j6 ^{+0.014} _{+0.011} | 200 | 0 | 12 | 3.5 | 4 | 180 | 195 | 155 | 250 | 340 | 416 |
| 100L | 750~3000 | 180j6 ^{+0.014} _{+0.011} | 250 | 0 | 14.5 | 4 | 4 | 205 | 215 | 180 | 270 | 375 | 450 |
| 112M | 750~3000 | 180j6 ^{+0.014} _{+0.011} | 250 | 0 | 14.5 | 4 | 4 | 230 | 240 | 190 | 300 | 399 | 460 |
| 132S | 750~3000 | 230j6 ^{+0.016} _{+0.013} | 300 | 0 | 14.5 | 4 | 4 | 270 | 275 | 210 | 345 | 464 | 520 |
| 132M | 750~3000 | 230j6 ^{+0.016} _{+0.013} | 300 | 0 | 14.5 | 4 | 4 | 320 | 275 | 210 | 345 | 502 | 558 |
| 160M | 750~3000 | 250j6 ^{+0.016} _{+0.013} | 350 | 0 | 18.5 | 5 | 4 | 320 | 330 | 255 | 420 | 610 | 650 |
| 160L | 750~3000 | 250j6 ^{+0.016} _{+0.013} | 350 | 0 | 18.5 | 5 | 4 | 355 | 330 | 255 | 420 | 655 | 695 |
| 180M | 750~3000 | 250j6 ^{+0.016} _{+0.013} | 350 | 0 | 18.5 | 5 | 4 | 355 | 380 | 280 | 455 | 691 | 737 |
| 180L | 750~3000 | 250j6 ^{+0.016} _{+0.013} | 350 | 0 | 18.5 | 5 | 4 | 395 | 380 | 280 | 455 | 729 | 775 |

注:表格内白底部分电机外壳材质为铝壳, 灰底部分电机外壳材质为铁壳

产品结构及安装型式 Motor structure and installation type

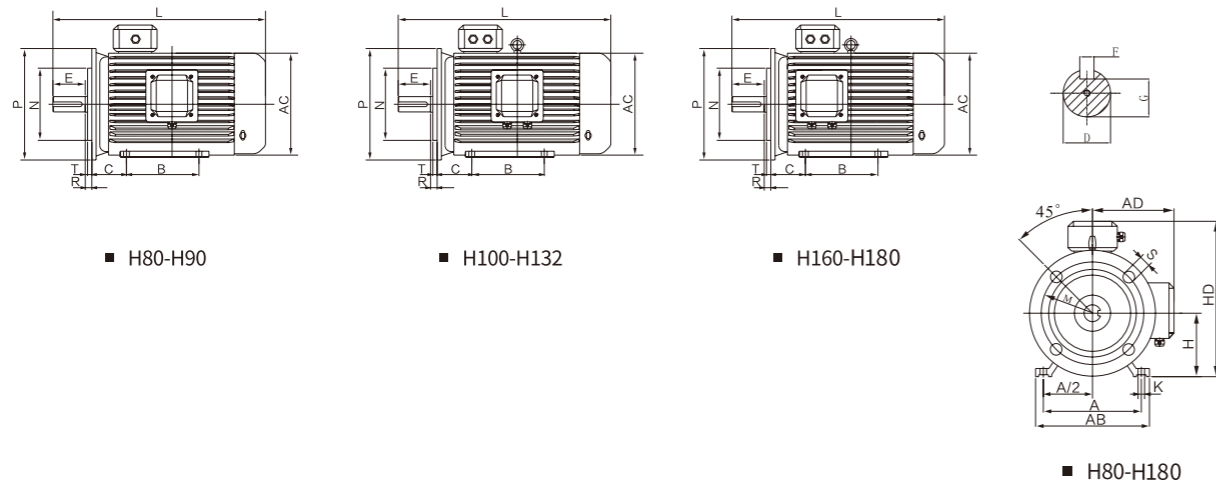
SMT变频调速永磁同步电机 异步机座安装及外形尺寸B35型
 B35 Type SMT Variable Frequency Speed Control Permanent Magnet Synchronous Motor Asynchronous Machine Basemotor Installation And External Dimensions

| 机座号 Frame Size | 转速 Speed (r/min) | D | E | F | G | M | N | P | R |
|-------------------|------------------------|--|---------------------------|---------------------------------------|--------------------------------------|-----|---|-----|---|
| 80 | 750~3000 | 19k6 ^{+0.015} / _{+0.002} | 40js9 _(±0.31) | 6N9 ⁰ / _{-0.03} | 15.5 ⁰ / _{-0.10} | 165 | 130j6 ^{+0.014} / _{+0.011} | 200 | 0 |
| 90S | 750~3000 | 24k6 ^{+0.015} / _{+0.002} | 50js9 _(±0.31) | 8N9 ⁰ / _{-0.036} | 20 ⁰ / _{-0.20} | 165 | 130j6 ^{+0.014} / _{+0.011} | 200 | 0 |
| 90L | 750~3000 | 24k6 ^{+0.015} / _{+0.002} | 50js9 _(±0.31) | 8N9 ⁰ / _{-0.036} | 20 ⁰ / _{-0.20} | 165 | 130j6 ^{+0.014} / _{+0.011} | 200 | 0 |
| 100L | 750~3000 | 28k6 ^{+0.015} / _{+0.002} | 60js9 _(±0.37) | 8N9 ⁰ / _{-0.036} | 24 ⁰ / _{-0.20} | 215 | 180j6 ^{+0.014} / _{+0.011} | 250 | 0 |
| 112M | 750~3000 | 28k6 ^{+0.015} / _{+0.002} | 60js9 _(±0.37) | 8N9 ⁰ / _{-0.036} | 24 ⁰ / _{-0.20} | 215 | 180j6 ^{+0.014} / _{+0.011} | 250 | 0 |
| 132S | 750~3000 | 38k6 ^{+0.018} / _{+0.002} | 80js9 _(±0.37) | 10N9 ⁰ / _{-0.036} | 33 ⁰ / _{-0.20} | 265 | 230j6 ^{+0.016} / _{+0.013} | 300 | 0 |
| 132M | 750~3000 | 38k6 ^{+0.018} / _{+0.002} | 80js9 _(±0.37) | 10N9 ⁰ / _{-0.036} | 33 ⁰ / _{-0.20} | 265 | 230j6 ^{+0.016} / _{+0.013} | 300 | 0 |
| 160M | 750~3000 | 42k6 ^{+0.018} / _{+0.002} | 110js9 _(±0.43) | 12N9 ⁰ / _{-0.043} | 37 ⁰ / _{-0.20} | 300 | 250j6 ^{+0.016} / _{+0.013} | 350 | 0 |
| 160L | 750~3000 | 42k6 ^{+0.018} / _{+0.002} | 110js9 _(±0.43) | 12N9 ⁰ / _{-0.043} | 37 ⁰ / _{-0.20} | 300 | 250j6 ^{+0.016} / _{+0.013} | 350 | 0 |
| 180M | 750~3000 | 48k6 ^{+0.018} / _{+0.002} | 110js9 _(±0.43) | 14N9 ⁰ / _{-0.043} | 42.5 ⁰ / _{-0.20} | 300 | 250j6 ^{+0.016} / _{+0.013} | 350 | 0 |
| 180L | 750~3000 | 48k6 ^{+0.018} / _{+0.002} | 110js9 _(±0.43) | 14N9 ⁰ / _{-0.043} | 42.5 ⁰ / _{-0.20} | 300 | 250j6 ^{+0.016} / _{+0.013} | 350 | 0 |

| 机座号 Frame Size | 转速 Speed (r/min) | S | T | 法兰孔数 Fange hdes | AC | AD | HE | L | L1 |
|-------------------|------------------------|------|-----|--------------------|-----|-----|-----|-----|-----|
| 80 | 750~3000 | 12 | 3.5 | 4 | 175 | 145 | 185 | 284 | 359 |
| 90S | 750~3000 | 12 | 3.5 | 4 | 195 | 155 | 195 | 315 | 391 |
| 90L | 750~3000 | 12 | 3.5 | 4 | 195 | 155 | 195 | 340 | 416 |
| 100L | 750~3000 | 14.5 | 4 | 4 | 215 | 180 | 245 | 375 | 450 |
| 112M | 750~3000 | 14.5 | 4 | 4 | 240 | 190 | 265 | 399 | 460 |
| 132S | 750~3000 | 14.5 | 4 | 4 | 275 | 210 | 315 | 464 | 520 |
| 132M | 750~3000 | 14.5 | 4 | 4 | 275 | 210 | 315 | 502 | 558 |
| 160M | 750~3000 | 18.5 | 5 | 4 | 330 | 255 | 385 | 610 | 650 |
| 160L | 750~3000 | 18.5 | 5 | 4 | 330 | 255 | 385 | 655 | 695 |
| 180M | 750~3000 | 18.5 | 5 | 4 | 380 | 280 | 430 | 691 | 737 |
| 180L | 750~3000 | 18.5 | 5 | 4 | 380 | 280 | 430 | 729 | 775 |

注:表格内白底部分电机外壳材质为铝壳, 灰底部分电机外壳材质为铁壳

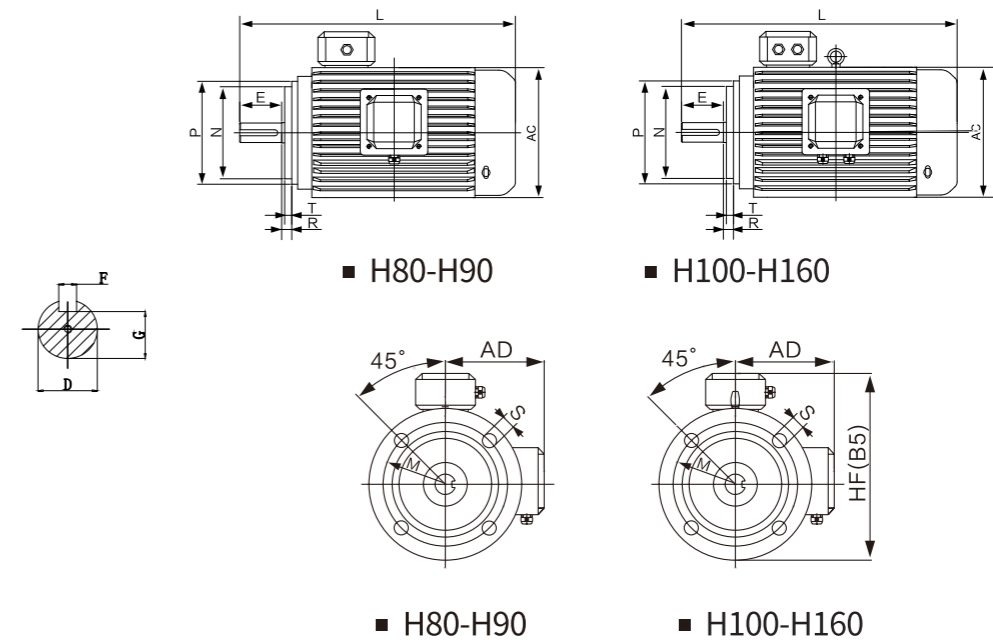
SMT变频调速永磁同步电机 铝壳 异步机座安装及外形尺寸B14型
 B14 Type SMT Variable Frequency Speed Control Permanent Magnet Synchronous Motor Aluminum Shell Asynchronous Machine Base Motor Installation And External Dimensions

| 机座号 Frame Size | 转速 Speed (r/min) | D | E | F | G | M | N | P | R |
|-------------------|------------------------|--|---------------------------|---------------------------------------|--------------------------------------|-----|---|-----|---|
| 80 | 750~3000 | 19k6 ^{+0.015} / _{+0.002} | 40js9 _(±0.31) | 6N9 ⁰ / _{-0.03} | 15.5 ⁰ / _{-0.10} | 100 | 80j6 ^{+0.014} / _{+0.011} | 120 | 0 |
| 90S | 750~3000 | 24k6 ^{+0.015} / _{+0.002} | 50js9 _(±0.31) | 8N9 ⁰ / _{-0.036} | 20 ⁰ / _{-0.20} | 115 | 95j6 ^{+0.014} / _{+0.011} | 140 | 0 |
| 90L | 750~3000 | 24k6 ^{+0.015} / _{+0.002} | 50js9 _(±0.31) | 8N9 ⁰ / _{-0.036} | 20 ⁰ / _{-0.20} | 115 | 95j6 ^{+0.014} / _{+0.011} | 140 | 0 |
| 100L | 750~3000 | 28k6 ^{+0.015} / _{+0.002} | 60js9 _(±0.37) | 8N9 ⁰ / _{-0.036} | 24 ⁰ / _{-0.20} | 130 | 110j6 ^{+0.014} / _{+0.011} | 160 | 0 |
| 112M | 750~3000 | 28k6 ^{+0.015} / _{+0.002} | 60js9 _(±0.37) | 8N9 ⁰ / _{-0.036} | 24 ⁰ / _{-0.20} | 130 | 110j6 ^{+0.014} / _{+0.011} | 160 | 0 |
| 132S | 750~3000 | 38k6 ^{+0.018} / _{+0.002} | 80js9 _(±0.37) | 10N9 ⁰ / _{-0.036} | 33 ⁰ / _{-0.20} | 165 | 130j6 ^{+0.016} / _{+0.013} | 200 | 0 |
| 132M | 750~3000 | 38k6 ^{+0.018} / _{+0.002} | 80js9 _(±0.37) | 10N9 ⁰ / _{-0.036} | 33 ⁰ / _{-0.20} | 165 | 130j6 ^{+0.016} / _{+0.013} | 200 | 0 |
| 160M | 750~3000 | 42k6 ^{+0.018} / _{+0.002} | 110js9 _(±0.43) | 12N9 ⁰ / _{-0.043} | 37 ⁰ / _{-0.20} | 215 | 180j6 ^{+0.016} / _{+0.013} | 250 | 0 |
| 160L | 750~3000 | 42k6 ^{+0.018} / _{+0.002} | 110js9 _(±0.43) | 12N9 ⁰ / _{-0.043} | 37 ⁰ / _{-0.20} | 215 | 180j6 ^{+0.016} / _{+0.013} | 250 | 0 |

| 机座号 Frame Size | 转速 Speed (r/min) | S | T | AC | AD | HE | L | L1 |
|-------------------|------------------------|-------|-----|-----|-----|-----|-----|-----|
| 80 | 750~3000 | 4xM6 | 3 | 175 | 145 | 185 | 284 | 359 |
| 90S | 750~3000 | 4xM8 | 3 | 195 | 155 | 195 | 315 | 391 |
| 90L | 750~3000 | 4xM8 | 3 | 195 | 155 | 195 | 340 | 416 |
| 100L | 750~3000 | 4xM8 | 3.5 | 215 | 180 | 245 | 375 | 450 |
| 112M | 750~3000 | 4xM8 | 3.5 | 240 | 190 | 265 | 399 | 460 |
| 132S | 750~3000 | 4xM10 | 3.5 | 275 | 210 | 315 | 464 | 520 |
| 132M | 750~3000 | 4xM10 | 3.5 | 275 | 210 | 315 | 502 | 558 |
| 160M | 750~3000 | 4xM12 | 4 | 330 | 255 | 385 | 610 | 650 |
| 160L | 750~3000 | 4xM12 | 4 | 330 | 255 | 385 | 655 | 695 |

注:表格内白底部分电机外壳材质为铝壳, 灰底部分电机外壳材质为铁壳

产品结构及安装型式 Motor structure and installation type

SMT变频调速永磁同步电机 铝壳 异步机座安装及外形尺寸B34型
B34 Type SMT Variable Frequency Speed Control Permanent Magnet Synchronous Motor Aluminum Shell Asynchronous Machine Base Motor Installation And External Dimensions

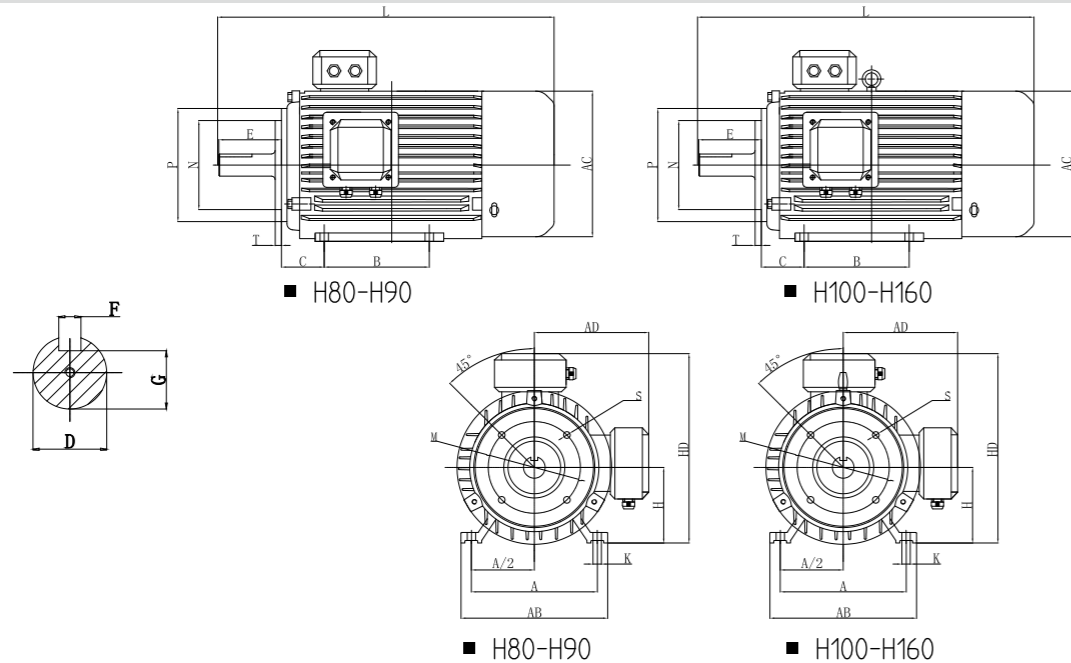

| 机座号 Frame Size | 转速 Speed (r/min) | A | A/2 | B | C | D | E | F | G | H | K | M |
|-------------------|------------------------|-----|------|-----|----------------------------|--|---------------------------|-------------------------------------|------------------------------------|-------------------------------------|------|------|
| 80 | 750~3000 | 125 | 62.5 | 100 | 50js14 _(±0.31) | 19k6 ^{+0.015} _{+0.002} | 40js9 _(±0.31) | 6N9 ⁰ _{-0.03} | 15.5 ⁰ _{-0.10} | 80 ^{-0.1} _{-0.4} | 10 | φ100 |
| 90S | 750~3000 | 140 | 70 | 100 | 56js14 _(±0.37) | 24k6 ^{+0.015} _{+0.002} | 50js9 _(±0.31) | 8N9 ⁰ _{-0.036} | 20 ⁰ _{-0.20} | 90 ^{-0.1} _{-0.4} | 10 | φ115 |
| 90L | 750~3000 | 140 | 70 | 125 | 56js14 _(±0.37) | 24k6 ^{+0.015} _{+0.002} | 50js9 _(±0.31) | 8N9 ⁰ _{-0.036} | 20 ⁰ _{-0.20} | 90 ^{-0.1} _{-0.4} | 10 | φ115 |
| 100L | 750~3000 | 160 | 80 | 140 | 63js14 _(±0.37) | 28k6 ^{+0.015} _{+0.002} | 60js9 _(±0.37) | 8N9 ⁰ _{-0.036} | 24 ⁰ _{-0.20} | 100 ^{-0.1} _{-0.4} | 12 | φ130 |
| 112M | 750~3000 | 190 | 95 | 140 | 70js14 _(±0.37) | 28k6 ^{+0.015} _{+0.002} | 60js9 _(±0.37) | 8N9 ⁰ _{-0.036} | 24 ⁰ _{-0.20} | 112 ^{-0.1} _{-0.4} | 12 | φ130 |
| 132S | 750~3000 | 216 | 108 | 140 | 89js14 _(±0.45) | 38k6 ^{+0.018} _{+0.002} | 80js9 _(±0.37) | 10N9 ⁰ _{-0.036} | 33 ⁰ _{-0.20} | 132 ^{-0.1} _{-0.4} | 12 | φ165 |
| 132M | 750~3000 | 216 | 108 | 178 | 89js14 _(±0.45) | 38k6 ^{+0.018} _{+0.002} | 80js9 _(±0.37) | 10N9 ⁰ _{-0.036} | 33 ⁰ _{-0.20} | 132 ^{-0.1} _{-0.4} | 12 | φ165 |
| 160M | 750~3000 | 254 | 127 | 210 | 108js14 _(±0.45) | 42k6 ^{+0.018} _{+0.002} | 110js9 _(±0.43) | 12N9 ⁰ _{-0.043} | 37 ⁰ _{-0.20} | 160 ^{-0.1} _{-0.4} | 14.5 | φ215 |
| 160L | 750~3000 | 254 | 127 | 254 | 108js14 _(±0.45) | 42k6 ^{+0.018} _{+0.002} | 110js9 _(±0.43) | 12N9 ⁰ _{-0.043} | 37 ⁰ _{-0.20} | 160 ^{-0.1} _{-0.4} | 14.5 | φ215 |

| 机座号 Frame Size | 转速 Speed (r/min) | N | P | R | S | T | AB | AC | AD | HD | L | L1 |
|-------------------|------------------------|---|------|---|-------|-----|-----|-----|-----|-----|-----|-----|
| 80 | 750~3000 | 130j6 ^{+0.014} _{+0.011} | φ120 | 0 | 4×M6 | 3 | 165 | 175 | 145 | 220 | 284 | 359 |
| 90S | 750~3000 | 130j6 ^{+0.014} _{+0.011} | φ140 | 0 | 4×M8 | 3 | 180 | 195 | 155 | 250 | 315 | 391 |
| 90L | 750~3000 | 130j6 ^{+0.014} _{+0.011} | φ140 | 0 | 4×M8 | 3 | 180 | 195 | 155 | 250 | 340 | 416 |
| 100L | 750~3000 | 180j6 ^{+0.014} _{+0.011} | φ160 | 0 | 4×M8 | 3.5 | 205 | 215 | 180 | 270 | 375 | 450 |
| 112M | 750~3000 | 180j6 ^{+0.014} _{+0.011} | φ160 | 0 | 4×M8 | 3.5 | 230 | 240 | 190 | 300 | 399 | 460 |
| 132S | 750~3000 | 230j6 ^{+0.016} _{+0.013} | φ200 | 0 | 4×M10 | 3.5 | 270 | 275 | 210 | 345 | 464 | 520 |
| 132M | 750~3000 | 230j6 ^{+0.016} _{+0.013} | φ200 | 0 | 4×M10 | 3.5 | 270 | 275 | 210 | 345 | 502 | 558 |
| 160M | 750~3000 | 250j6 ^{+0.016} _{+0.013} | φ250 | 0 | 4×M12 | 4 | 320 | 330 | 255 | 420 | 610 | 650 |
| 160L | 750~3000 | 250j6 ^{+0.016} _{+0.013} | φ250 | 0 | 4×M12 | 4 | 320 | 330 | 255 | 420 | 655 | 695 |

注:表格内白底部分电机外壳材质为铝壳, 灰底部分电机外壳材质为铁壳

TYE5异步起动永磁同步电机安装及外形尺寸B3型
B3 Type TYE5 Asynchronous Starter Permanent Magnet Synchronous Motor Installation And External Dimensions

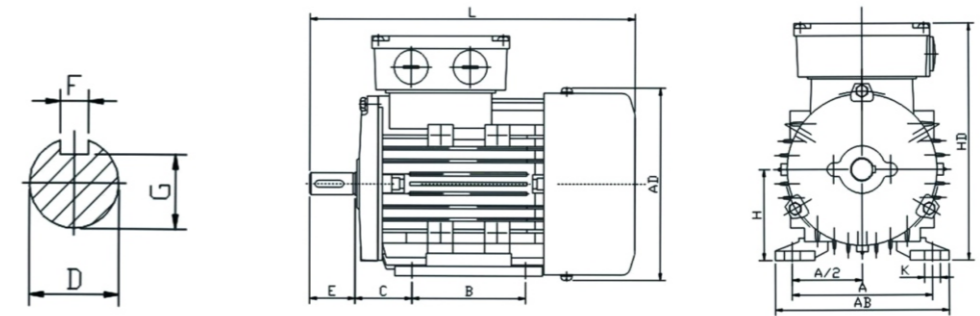

| 机座号 Frame Size | 转速 Speed (r/min) | C | B | A | A/2 | K | H | E | D | F |
|-------------------|------------------------|-----|-----|-----|------|----|-----|-----|----|----|
| 80M | 750~3000 | 50 | 100 | 125 | 62.5 | 10 | 80 | 40 | 19 | 6 |
| 90S | 750~3000 | 56 | 100 | 140 | 70 | 10 | 90 | 50 | 24 | 8 |
| 90L | 750~3000 | 56 | 125 | 140 | 70 | 10 | 90 | 50 | 24 | 8 |
| 100L | 750~3000 | 63 | 140 | 160 | 80 | 12 | 100 | 60 | 28 | 8 |
| 112M | 750~3000 | 70 | 140 | 190 | 95 | 12 | 112 | 60 | 28 | 8 |
| 132S | 750~3000 | 89 | 140 | 216 | 108 | 12 | 132 | 80 | 38 | 10 |
| 132M | 750~3000 | 89 | 178 | 216 | 108 | 12 | 132 | 80 | 38 | 10 |
| 160M | 750~3000 | 108 | 210 | 254 | 127 | 15 | 160 | 110 | 42 | 12 |
| 160L | 750~3000 | 108 | 254 | 254 | 127 | 15 | 160 | 110 | 42 | 12 |

| 机座号 Frame Size | 转速 Speed (r/min) | G | AC | AB | HD | L | AD |
|-------------------|------------------------|------|-----|-----|-----|-----|-----|
| 80M | 750~3000 | 15.5 | 175 | 165 | 220 | 295 | 145 |
| 90S | 750~3000 | 20 | 195 | 180 | 250 | 320 | 155 |
| 90L | 750~3000 | 20 | 195 | 180 | 250 | 345 | 155 |
| 100L | 750~3000 | 24 | 215 | 205 | 270 | 385 | 180 |
| 112M | 750~3000 | 24 | 240 | 230 | 300 | 400 | 190 |
| 132S | 750~3000 | 33 | 275 | 270 | 345 | 470 | 210 |
| 132M | 750~3000 | 33 | 275 | 270 | 345 | 510 | 210 |
| 160M | 750~3000 | 37 | 330 | 320 | 420 | 615 | 255 |
| 160L | 750~3000 | 37 | 330 | 320 | 420 | 670 | 255 |

产品结构及安装型式 Motor structure and installation type

TYE5异步起动永磁同步电机安装及外形尺寸B14型

B14 Type TYE5 Asynchronous Starter Permanent Magnet Synchronous Motor Installation And External Dimensions

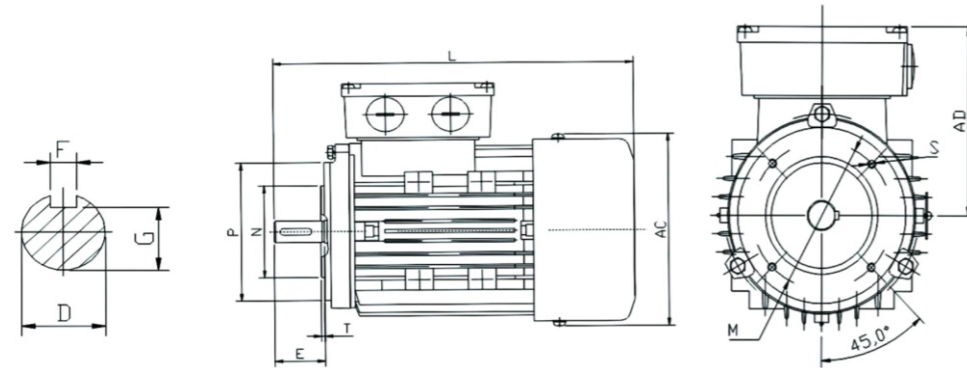

| 机座号 Frame Size | 转速 Speed (r/min) | M | N | P | S | T | D | E | F |
|-------------------|------------------------|-----|-----|-----|-----|-----|----|-----|----|
| 80M | 750~3000 | 100 | 80 | 120 | M6 | 3 | 19 | 40 | 6 |
| 90S | 750~3000 | 115 | 95 | 140 | M8 | 3 | 24 | 50 | 8 |
| 90L | 750~3000 | 115 | 95 | 140 | M8 | 3 | 24 | 50 | 8 |
| 100L | 750~3000 | 130 | 110 | 160 | M8 | 3.5 | 28 | 60 | 8 |
| 112M | 750~3000 | 130 | 110 | 160 | M8 | 3.5 | 28 | 60 | 8 |
| 132S | 750~3000 | 165 | 130 | 160 | M10 | 4 | 38 | 80 | 10 |
| 132M | 750~3000 | 165 | 130 | 160 | M10 | 4 | 38 | 80 | 10 |
| 160M | 750~3000 | 215 | 180 | 250 | M12 | 4 | 42 | 110 | 12 |
| 160L | 750~3000 | 215 | 180 | 250 | M12 | 4 | 42 | 110 | 12 |

| 机座号 Frame Size | 转速 Speed (r/min) | G | AC | AB | Y2 | HF |
|-------------------|------------------------|------|-----|-----|-----|-----|
| 80M | 750~3000 | 15.5 | 175 | 145 | 295 | 185 |
| 90S | 750~3000 | 20 | 195 | 155 | 320 | 195 |
| 90L | 750~3000 | 20 | 195 | 155 | 345 | 195 |
| 100L | 750~3000 | 24 | 215 | 180 | 385 | 245 |
| 112M | 750~3000 | 24 | 240 | 190 | 400 | 265 |
| 132S | 750~3000 | 33 | 263 | 195 | 393 | 330 |
| 132M | 750~3000 | 33 | 263 | 195 | 511 | 330 |
| 160M | 750~3000 | 37 | 330 | 255 | 615 | 358 |
| 160L | 750~3000 | 37 | 330 | 255 | 670 | 358 |

TYE5异步起动永磁同步电机安装及外形尺寸B5型

B15 Type TYE5 Asynchronous Starter Permanent Magnet Synchronous Motor installation and external dimensions

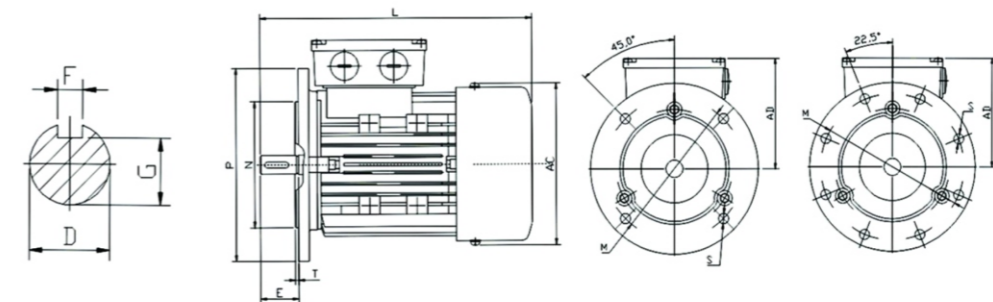

| 机座号 Frame Size | 转速 Speed (r/min) | M | N | P | S | T | D | E | F |
|-------------------|------------------------|-----|-----|-----|----|-----|----|-----|----|
| 80M | 750~3000 | 165 | 130 | 200 | 12 | 3.5 | 19 | 40 | 6 |
| 90S | 750~3000 | 165 | 130 | 200 | 12 | 3.5 | 24 | 50 | 8 |
| 90L | 750~3000 | 165 | 130 | 200 | 12 | 3.5 | 24 | 50 | 8 |
| 100L | 750~3000 | 215 | 180 | 250 | 15 | 4 | 28 | 60 | 8 |
| 112M | 750~3000 | 215 | 180 | 250 | 15 | 4 | 28 | 60 | 8 |
| 132S | 750~3000 | 265 | 230 | 300 | 15 | 4 | 38 | 80 | 10 |
| 132M | 750~3000 | 265 | 230 | 300 | 15 | 4 | 38 | 80 | 10 |
| 160M | 750~3000 | 300 | 250 | 350 | 19 | 5 | 42 | 110 | 12 |
| 160L | 750~3000 | 300 | 250 | 350 | 19 | 5 | 42 | 110 | 12 |

| 机座号 Frame Size | 转速 Speed (r/min) | G | AC | AB | L | HF |
|-------------------|------------------------|------|-----|-----|-----|-----|
| 80M | 750~3000 | 15.5 | 175 | 145 | 295 | 185 |
| 90S | 750~3000 | 20 | 195 | 155 | 320 | 195 |
| 90L | 750~3000 | 20 | 195 | 155 | 345 | 195 |
| 100L | 750~3000 | 24 | 215 | 180 | 385 | 245 |
| 112M | 750~3000 | 24 | 240 | 190 | 400 | 265 |
| 132S | 750~3000 | 33 | 275 | 210 | 470 | 315 |
| 132M | 750~3000 | 33 | 275 | 210 | 510 | 315 |
| 160M | 750~3000 | 37 | 330 | 255 | 615 | 385 |
| 160L | 750~3000 | 37 | 330 | 255 | 670 | 385 |

